





GENUINE REAR DISC PAD

INSTALLATION AND USER'S INSTRUCTIONS

Thank you for purchasing a genuine Mazda accessory.
Before removal and installation, be sure to thoroughly read these instructions.
Please read the contents of this booklet in order to properly install and use the rear disc pad. Your safety depends on it.
Keep these instructions with your vehicle records for future reference.

WARNING

- There are several  **WARNING** and  **CAUTION** sections in this booklet concerning safety when installing or removing the rear disc pad. Always read and follow them in order to prevent injuries, accidents, and possible damage to the vehicle.
 -  **WARNING:** Indicates a situation in which serious injury or death could result if the warning is ignored.
 -  **CAUTION:** Indicates a situation in which bodily injury or damage to the vehicle could result if the caution is ignored.
- Do not modify the rear disc pad.
- Do not install the rear disc pad in any way other than described in the following instructions.
- If in any doubt, please ask your Mazda dealer to install the accessory in order to prevent errors in installation.
- If you have any questions about the use of the accessory, ask your Mazda dealer for proper advice before using it.
- Mazda and its suppliers are not responsible for injuries, accidents, and damage to persons and property that arise from the failure of the dealer or installer to follow these instructions.
- To ensure safety and reliability of the work, installation, removal and disposal work must be carried out by an Authorized Mazda Dealership.
- Be careful not to lose removed parts, and be sure that they are kept free from scratches, grease or other dirt.

PART NAME: REAR DISC PAD

PART NUMBER: QSEA 49 480

VEHICLE: Mazda RX-8

NOTE

To the dealer

- Please turn over these instructions to the customer after installation.

To the customer

- Keep these instructions after installation. The instructions may be necessary for installing other optional parts or removal of this accessory.
- Should the vehicle or this accessory be resold, always leave these instructions with it for the next owner.

1 PARTS

Note

- Verify that the kit includes all the following parts and that they are free of dirt, scratches, or damage.

Part name	Qty.
Rear disc pad	4

2 BEFORE INSTALLATION

REQUIRED TOOLS

Prepare the following tools or items before installation.

- ★Wrench
- ★49 F043 002 (Special service tool)

3 REAR DISC PAD INSTALLATION

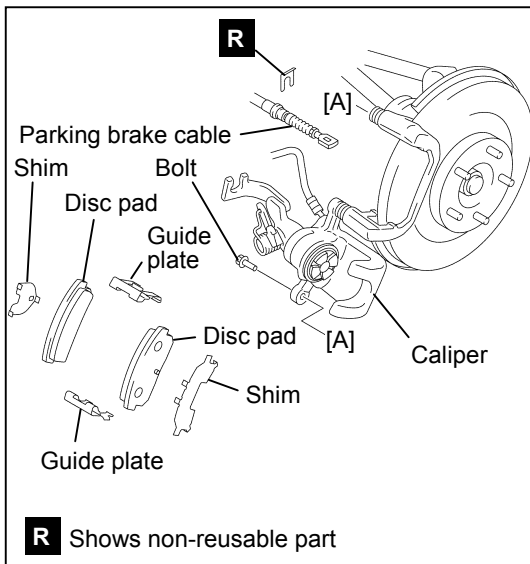

1. Remove the parking brake cable.
2. Remove the bolt.
3. Slide the caliper to the position shown in the figure.
4. Remove the disc pads from the mounting support.
5. Remove the (shims and guide plates) . Store the removed parts away from dirt, as they will be reused.

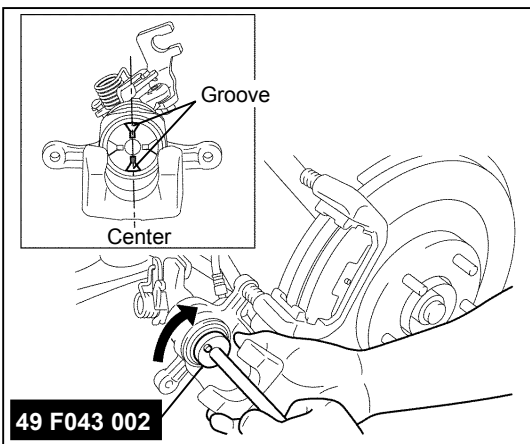

6. Clean the exposed area of the piston.
7. Rotate the piston clockwise slowly using the special service tool, 49 F043 002, and push in the piston completely until the piston grooves are in the position shown in the figure.
8. Install the guide plates to the mounting support.
9. Install the shims. to the disc pads.
10. Install the disc pads to the mounting support.
11. Put the caliper back into position.
12. Secure the caliper to the mounting support with the bolt and tighten it to the specified torque.

Tightening torque:

21.58-31.38 N·m

{2.201-3.199 kgf·m, 15.92-23.14 ft·lbf}

13. Install the parking brake cable removed in step 1.

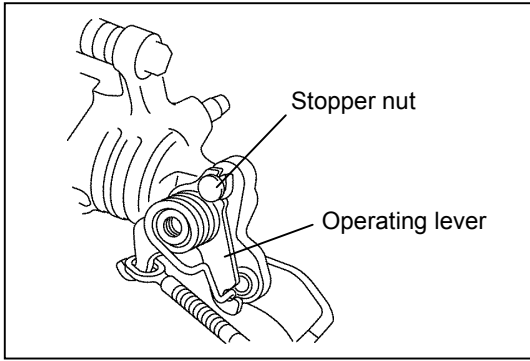

14. After installing the parking brake cable, verify that the operating lever returns to the stopper nut with the parking brake lever released.

15. After installation, depress the brake pedal a few times, and inspect the following:

- The disc pad projection is securely installed to the piston groove
- Parking brake lever stroke
- Brake drag

⚠ CAUTION

- The brakes may not initially perform at maximum braking force for a period after the pads have been replaced because the pads and rotors require a break-in period. Avoid sudden braking and apply brakes for a sufficient amount of time until the brake pads and rotors are broken-in.
(About 100 km of driving on city streets is needed for brake pads and rotors to be broken-in.)