

# REFRIGERANT LINES

## REFRIGERANT LINE REMOVAL/INSTALLATION

1. Remove the battery.
2. Remove the fresh-air duct and air cleaner. (See INTAKE-AIR SYSTEM REMOVAL/INSTALLATION .)
3. Discharge the refrigerant from the system. (See REFRIGERANT CHARGING .)
4. Remove the front side marker light. (See FRONT SIDE MARKER LIGHT REMOVAL/INSTALLATION .)
5. Remove the front bumper. (See FRONT BUMPER REMOVAL/INSTALLATION .)
6. Remove the drive belt. (See DRIVE BELT REPLACEMENT .)
7. Do not allow remaining compressor oil in the piping and connecting parts to spill, and remove in the order indicated in the table.

### CAUTION:

- If moisture or foreign material enters the refrigeration cycle, cooling ability will be lowered and abnormal noise or other malfunction could occur. Always plug open fittings immediately after removing any refrigeration cycle parts.

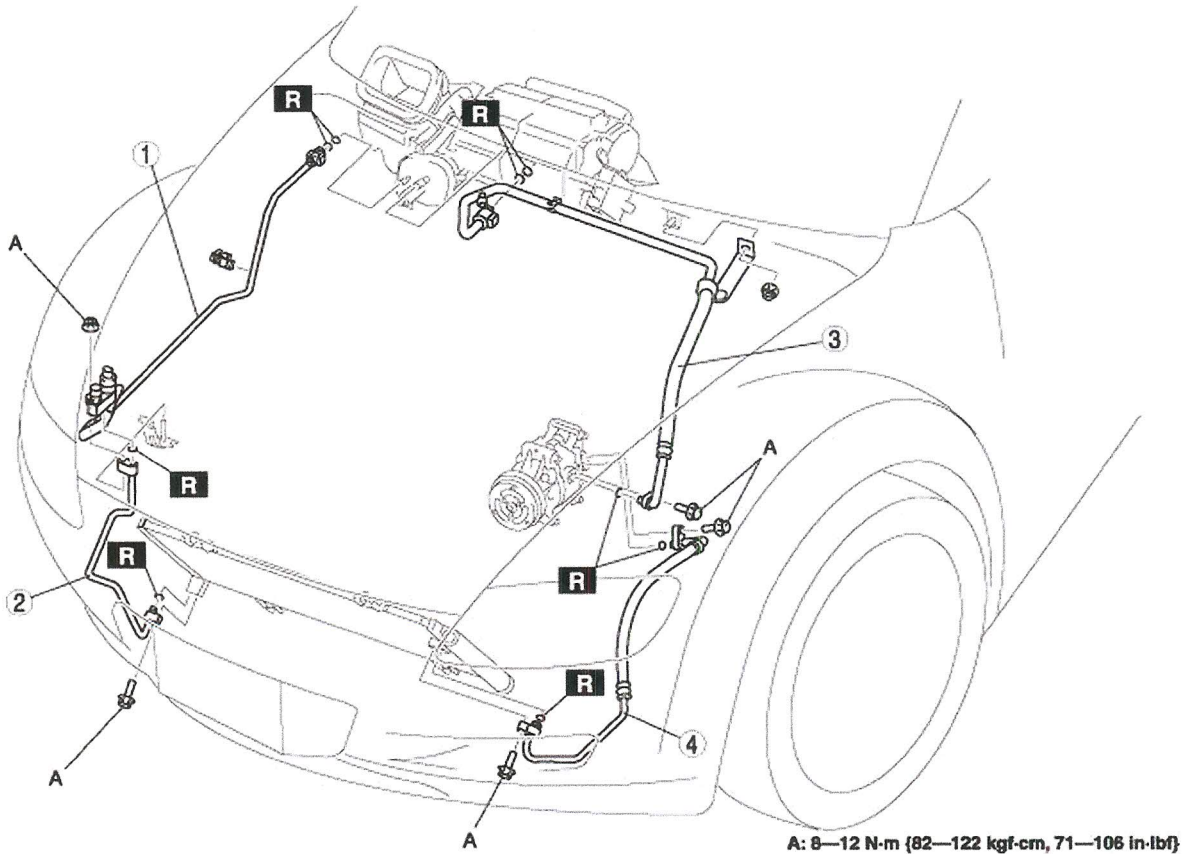

Cooler pipe No.2

1 (See Refrigerant Line Removal Note .)