

A. VEHICLE INSPECTION PROCEDURE

1. Verify that the vehicle is within the following ranges:
 - 2004 RX-8 vehicles with VIN range JM1 FE17** 40 100053 – 129716 built from April 23, 2003 through December 27, 2003.
 - If the vehicle is within the above range, proceed to step 2.
 - If the vehicle is not within the above range, return the vehicle to the customer or inventory.
2. Perform a Warranty Vehicle Inquiry using your eMDCS System and inspect vehicle for a Campaign Label **3405G** attached to the vehicle's hood or bulkhead. Refer to eMDCS System - Warranty Vehicle Inquiry Results table below.

NOTE: Verify Recall number as the vehicle may have multiple Recalls.

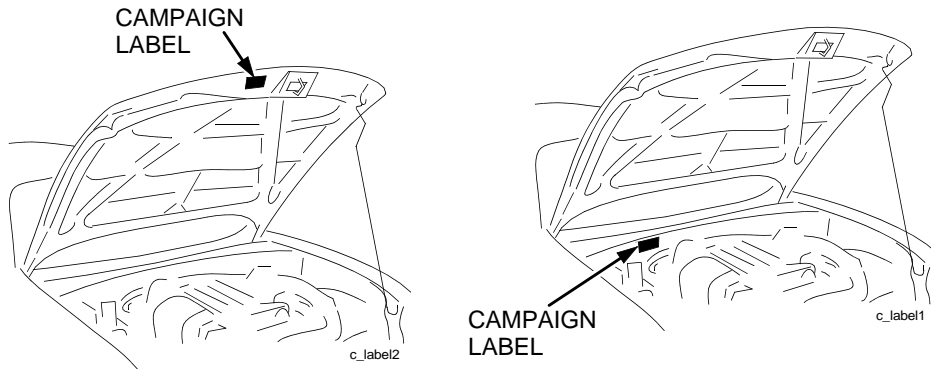

CAMPAIGN LABEL

CAMPAIGN NO: _____

DEALER CODE: _____

DATE: // /

P/N 9999-95-065A-05

1326b

eMDCS System - Warranty Vehicle Inquiry Results

If eMDCS displays:	Campaign Label is:	Action to perform:
3405G OPEN	Present	Contact the Mazda Corporate Dealer Assistance Group at (877) 727-6626 to update vehicle history.
	Not present	Proceed to "B. REPAIR PROCEDURE".
3405G CLOSED	Present	Return vehicle to inventory or customer.
	Not present	Complete a label and apply to vehicle's hood or bulkhead.
3405G is not displayed	Does not apply	SSP does not apply to this vehicle. Return vehicle to inventory or customer.

B. REPAIR PROCEDURE

1. Raise and support vehicle.
2. Check the cast numbers on the under side of **both** front lower arms.
 - If the either of the front lower arms have the combination of both K4 and (diamond) 1 as shown, go to step 3.
 - If the front lower arms **DO NOT** have the combination of K4 and (diamond) 1, lower vehicle and return vehicle to inventory or customer. Proceed to "C. CAMPAIGN LABEL INSTALLATION".

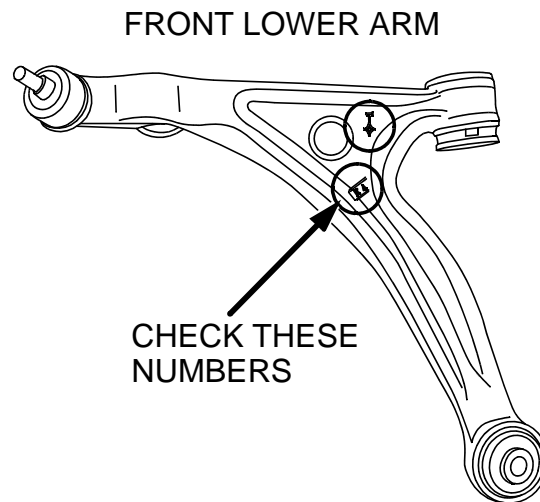

IF K4 AND \diamond 1 ARE BOTH PRESENT, REPLACE

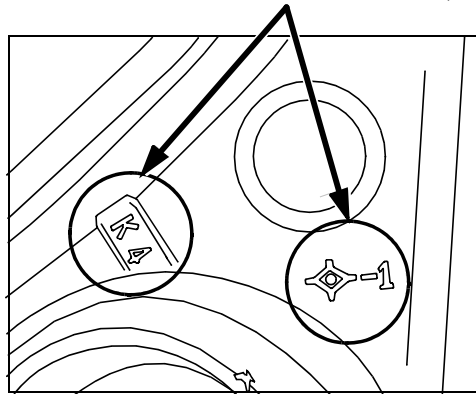

3. Replace lower arm showing combination of both K4 and (diamond) 1. Refer to Workshop manual section 02-13 FRONT LOWER ARM REMOVAL / INSTALLATION.
4. Align vehicle to specification. Refer to Workshop manual section 02-11 WHEEL ALIGNMENT.
5. Go to "C. CAMPAIGN LABEL INSTALLATION".

C. CAMPAIGN LABEL INSTALLATION

Complete a "Campaign Label" with the Recall number written on the sticker and affix it to the vehicle's hood or bulkhead. Refer back to the illustration under "A. VEHICLE INSPECTION PROCEDURE".