

2003-2009 ALL MODELS WITH NAVIGATION SETTING / DELETING HOME LOCATION RI6156

2004-2009 Mazda3, 2006-2007 Mazda5, 2003-2008 Mazda6, 2004-2008 RX-8,
2007-2008 CX-9, 2007-2009 CX-7

Select memory point from list to set as home location.

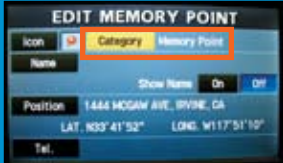
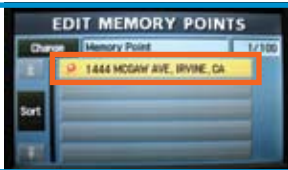

Select CATEGORY to change memory point to home location.

After memory point has been changed to home location, this screen will confirm.



SETTING HOME LOCATION

1. Press MENU button.
2. Select Address Book from NAVIGATION MENU screen.
3. Select Memory Points/Home from ADDRESS BOOK screen.
4. Select Add from MEMORY POINTS screen.
5. Select Address, Point of Interest, Memory Point, Previous Destinations or Coordinates from STORE MEMORY POINT screen (we will use Address for this example).
6. Enter address.
7. Select the Memory Pt. on screen button at the lower right corner. "Stored as Memory Point." box will appear after selecting. Screen will automatically default back to the ADDRESS BOOK screen
8. Select Memory Points/Home from ADDRESS BOOK screen.
9. Select List from MEMORY POINTS screen.
10. Select the memory point you want to set as HOME from the EDIT MEMORY POINTS screen.
11. Select the "Category" on-screen button located at the top center of the EDIT MEMORY POINT screen.
12. Select Home from EDIT MEMORY POINT screen. "Category changed. Memory Point Home" box will be displayed. Screen will automatically default back to the EDIT MEMORY POINTS screen.
13. Press the NAVI or POS button to return to the map screen.

DELETING HOME LOCATION

1. Press MENU button.
2. Select Address Book from NAVIGATION MENU screen.
3. Select Memory Points/Home from ADDRESS BOOK screen.
4. Select Delete from MEMORY POINTS screen.
5. Select Change from the DELETE MEMORY POINTS screen until Home is displayed.
6. Select Home from the DELETE MEMORY POINTS screen. "Delete Home Position?" box will appear. Select Yes. "Home Position deleted." box will appear. The screen will automatically return to the ADDRESS BOOK screen.
7. Press the NAVI or POS button to return to the map screen.

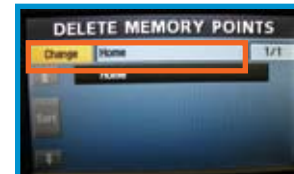

Press CHANGE to select HOME. Select HOME to delete home location.

Select YES to confirm deleting of home location.

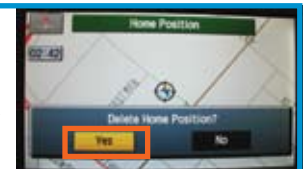

2003-2009 ALL MODELS WITH NAVIGATION SETTING / DELETING HOME LOCATION (CONT.)

2008 Mazda5, 2009 CX-9, 2009 RX-8, 2009 Mazda6



Select ADD, LIST or DELETE depending on desired action.

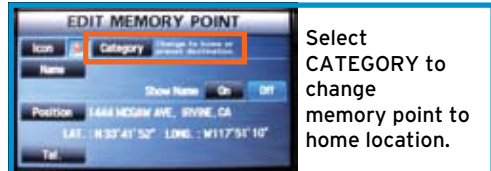

Select CATEGORY to change memory point to home location.

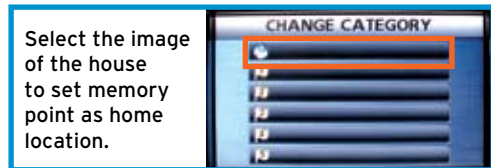

Select the image of the house to set memory point as home location.

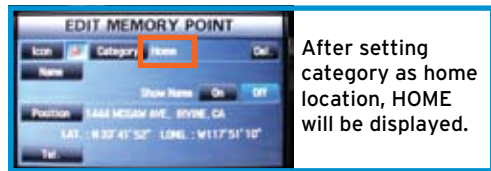

After setting category as home location, HOME will be displayed.

SETTING HOME LOCATION

1. Press MENU button.
2. Select Address Book from NAVIGATION MENU screen.
3. Select Memory Points/Home from ADDRESS BOOK screen.
4. Select Add from MEMORY POINTS screen.
5. Select Address, Point of Interest, Memory Point, Previous Destinations or Coordinates from STORE MEMORY POINT screen (we will use Address for this example).
6. Enter address.
7. Select the Memory Pt. on screen button at the lower right corner. Stored as Memory Point box will appear after selecting. Screen will automatically default back to the ADDRESS BOOK screen.
8. Select Memory Points/Home from ADDRESS BOOK screen.
9. Select List from MEMORY POINTS screen.
10. Select the memory point you want to set as HOME from the EDIT MEMORY POINTS screen.
11. Select the "Category" on-screen button located at the top center of the EDIT MEMORY POINT screen.
12. Select the image of the house located at the top of the CHANGE CATEGORY screen. The screen will automatically return to the EDIT MEMORY POINT screen. Next to the "Category" on-screen button, Home will be displayed.
13. Press the MAP button to return to the map screen.

MODIFYING HOME LOCATION

1. Press MENU button.
2. Select Address Book from NAVIGATION MENU screen.
3. Select Memory Points/Home from ADDRESS BOOK screen.
4. Select List from MEMORY POINTS screen.
5. Select the Home memory point from the EDIT MEMORY POINTS screen. The icon located next to the name will be a house.
6. Select the Del. on-screen button located at the top right of the EDIT MEMORY POINT screen.
7. "Delete your home attribute?" box will appear after selecting. Select Yes. The screen will automatically return to the EDIT MEMORY POINT and next to the "Category" on-screen button, "Change to home or preset destination." will be displayed. The screen will automatically return to the EDIT MEMORY POINT screen.
8. Press the MAP button to return to the map screen.



Select DEL to remove memory point as home location.



Select YES to confirm deleting of home location attribute.

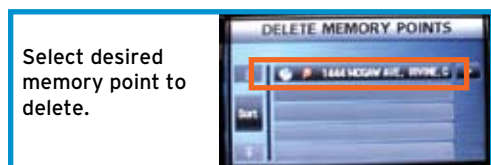

Select desired memory point to delete.

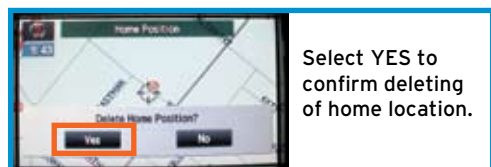

Select YES to confirm deleting of home location.

DELETING HOME LOCATION

1. Press MENU button.
2. Select Address Book from NAVIGATION MENU screen.
3. Select Memory Points/Home from ADDRESS BOOK screen.
4. Select Delete from MEMORY POINTS screen.
5. Select the Home memory point from the EDIT MEMORY POINTS screen. The icon located next to the name will be a house.
6. "Delete Home Position?" box will appear after selecting. Select Yes. "Home Position deleted." box will appear. The screen will automatically return to the ADDRESS BOOK screen.
7. Press the MAP button to return to the map screen.