

## THERMOSTAT REMOVAL/INSTALLATION

### WARNING:

- Remove and install all parts when the engine is cold, otherwise they can cause severe burns or serious injury.
1. Remove the engine cover. (See ENGINE COVER REMOVAL/INSTALLATION .)
  2. Remove the battery cover.
  3. Disconnect the negative battery cable. (See BATTERY REMOVAL/INSTALLATION .)
  4. Drain the engine coolant. (See ENGINE COOLANT REPLACEMENT .)
  5. Remove the battery, battery box. (See BATTERY REMOVAL/INSTALLATION .)
  6. Remove the secondary air control valve. (See SECONDARY AIR INJECTION (AIR) CONTROL VALVE REMOVAL/INSTALLATION .)
  7. Before positioning the drive belt out of the way, loosen the water pump pulley installation bolt.
  8. Position the drive belt out of the way. (See DRIVE BELT REPLACEMENT .)
  9. Remove the water pump pulley. (See WATER PUMP REMOVAL/INSTALLATION .)
  10. Remove in the order indicated in the table.
  11. Install in the reverse order of removal.

### Thermostat Installation Note

1. Install the thermostat by fitting the projection on the thermostat to the recess of the thermostat case.

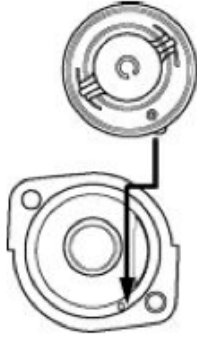

2. Install the thermostat.

### THERMOSTAT INSPECTION

1. Inspect the thermostat for the following.

#### WARNING:

- During inspection, the thermostat and water are extremely hot and they can cause burns. Do not touch the thermostat and water.
- The valve shall not open under normal temperature.
- Opening temperature and valve lift
  - If there is any malfunction, replace the thermostat.

Item		Specification
Initial-opening temperature	(°C {°F})	80—84 {176—183}
Full-open temperature	(°C {°F})	95 {203}
Full-open lift	(mm {in})	8.5 {0.33} or more

12. Add engine coolant. (See ENGINE COOLANT REPLACEMENT .)

13. Inspect for engine coolant leakage. (See ENGINE COOLANT LEAKAGE INSPECTION .)

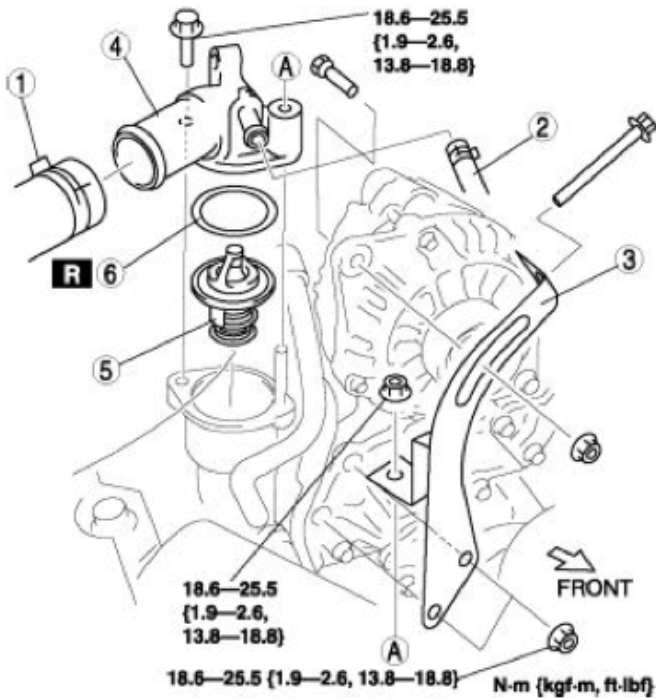

1	Upper radiator hose
2	Hose
3	Generator strap
4	Thermostat cover
5	Thermostat (See Thermostat Installation Note .)
6	O-ring