

2710A REAR DIFFERENTIALS

(1/2)

(MT)
((AT) > (L. S. DIFF.))

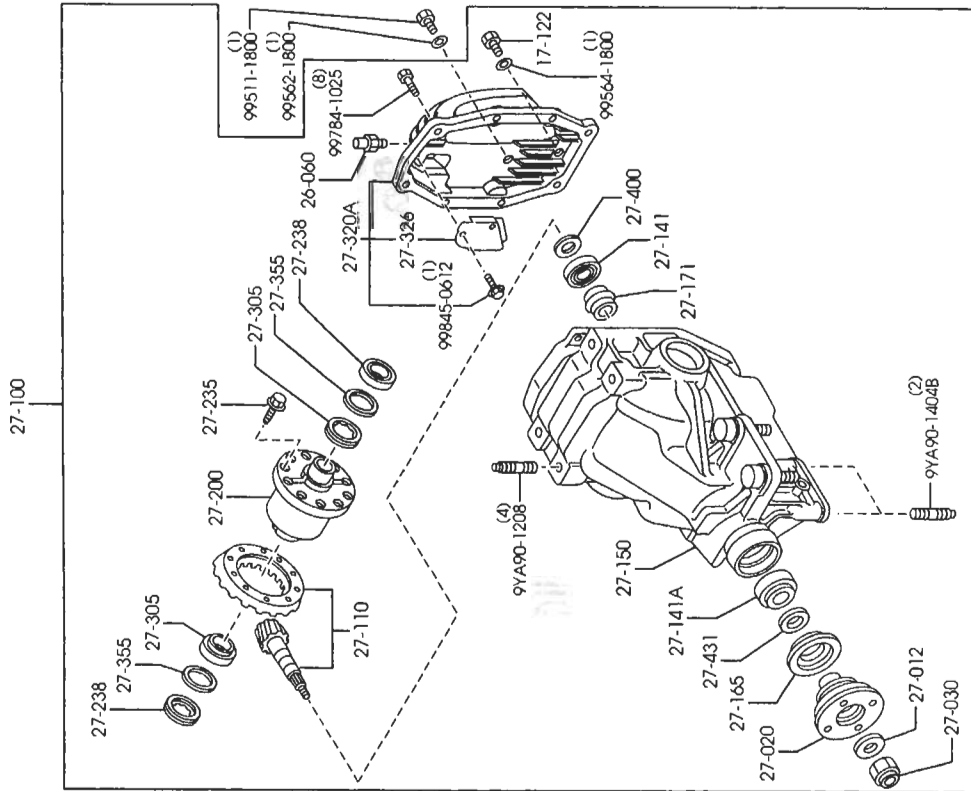

2710A -1 REAR DI

PART NO.	QTY	MODEL/RESTRICTION	MODEL/RESTRICTION	MODEL/RESTRICTION	FRONT
17-122	1	PLUG, MAGNET	BOUCHON, ATMANT		
0810-17-121	1				
28-060	1	BREATHER	BOUCHON		
0730-26-060	1				
27-012	1	WASHER	RONDELLE		
0223-27-012	1				
27-020	1	FLANGE, COMPANION	BRIDE		
P045-27-120B	1	(MT)	(B. V. MANU)		
RA13-27-120	1	(AT)	(B. V. AUTOM)		
27-030	1	NUT, LOCK	ECROU DE SERRAGE		
0223-27-030	1				
27-100	1	DRIVING & DIFF.	CARTER PONT AV. ASSE		
RA14-27-100D	1	((AT)) > (NOR. DIFF.)	ROULEMENT (AV.), PIGNON		
RS03-27-100F	1	(MT)	(B. V. MANU)		
RS04-27-100E	1	((AT)) > (L. S. DIFF.)	((B. V. AUTOM)) > (DIFF AU T-BLO.)		
27-110	1	GEAR SET, FINAL	COUPLE CONIQUE		
PA28-27-110	1				
27-141	1	BEARING, PINION	ROULEMENT (AV.), PIGNON		
R001-27-210	1				
27-161A	1	BEARING, PINION	ROULEMENT (ARR.), PIGNON		
0604-27-220	1				
27-150	1	CARRIER, DIFFERENTIAL	DIFFERENTIEL, SUPPORT		
RA12-27-150B	1				
27-165	1	SEAL, OIL	ARRET D'HUILE		
RA02-27-165	1	(AT)	(B. V. AUTOM)		
RA03-27-165A	1	(MT)	(B. V. MANU)		
27-171	1	PIECE, DISTANCE	BUSELURE DE SEPARATION		
R004-27-171A	1				

CAT. AUF07-00

2003-01



JF-AU/