

FUEL SYSTEM

7. Remove in the order indicated in the table.
8. Install in the reverse order of removal.
9. Inspect all parts by performing the "AFTER REPAIR PROCEDURE". (See 01-14-5 AFTER REPAIR PROCEDURE.)

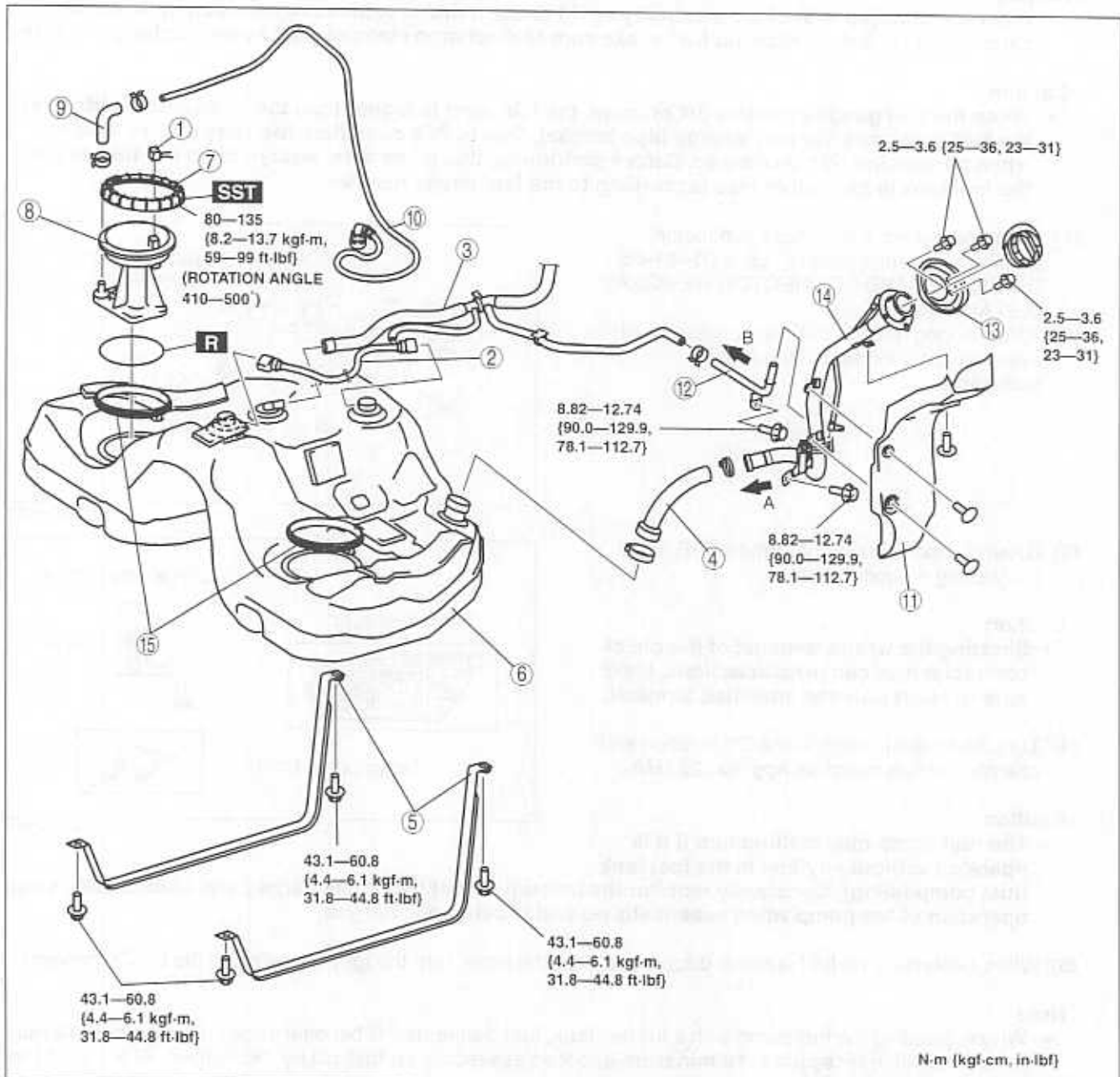

CHU0114W027

1	Connector
2	Evaporative hose (See 01-14-30 Rollover Valve.)
3	Breather hose (See 01-14-29 Fuel Shut-off Valve.)
4	Joint hose (See 01-14-10 Joint Hose Installation Note.)
5	Strap
6	Fuel tank
7	Cap (See 01-14-9 Cap Removal Note.) (See 01-14-9 Cap Installation Note.)
8	Fuel suction pipe bracket

9	Fuel suction hose
10	Fuel suction pipe
11	Protector
12	Joint pipe (See 01-14-27 Fuel Tank Side (Except for Fuel Shut-off/Rollover Valve).)
13	Dust cover
14	Fuel-filler pipe (See 01-14-9 Fuel-filler Pipe Removal Note.)
15	Retainer

FUEL SYSTEM

FUEL SYSTEM DIAGRAM

CHU011401006W02

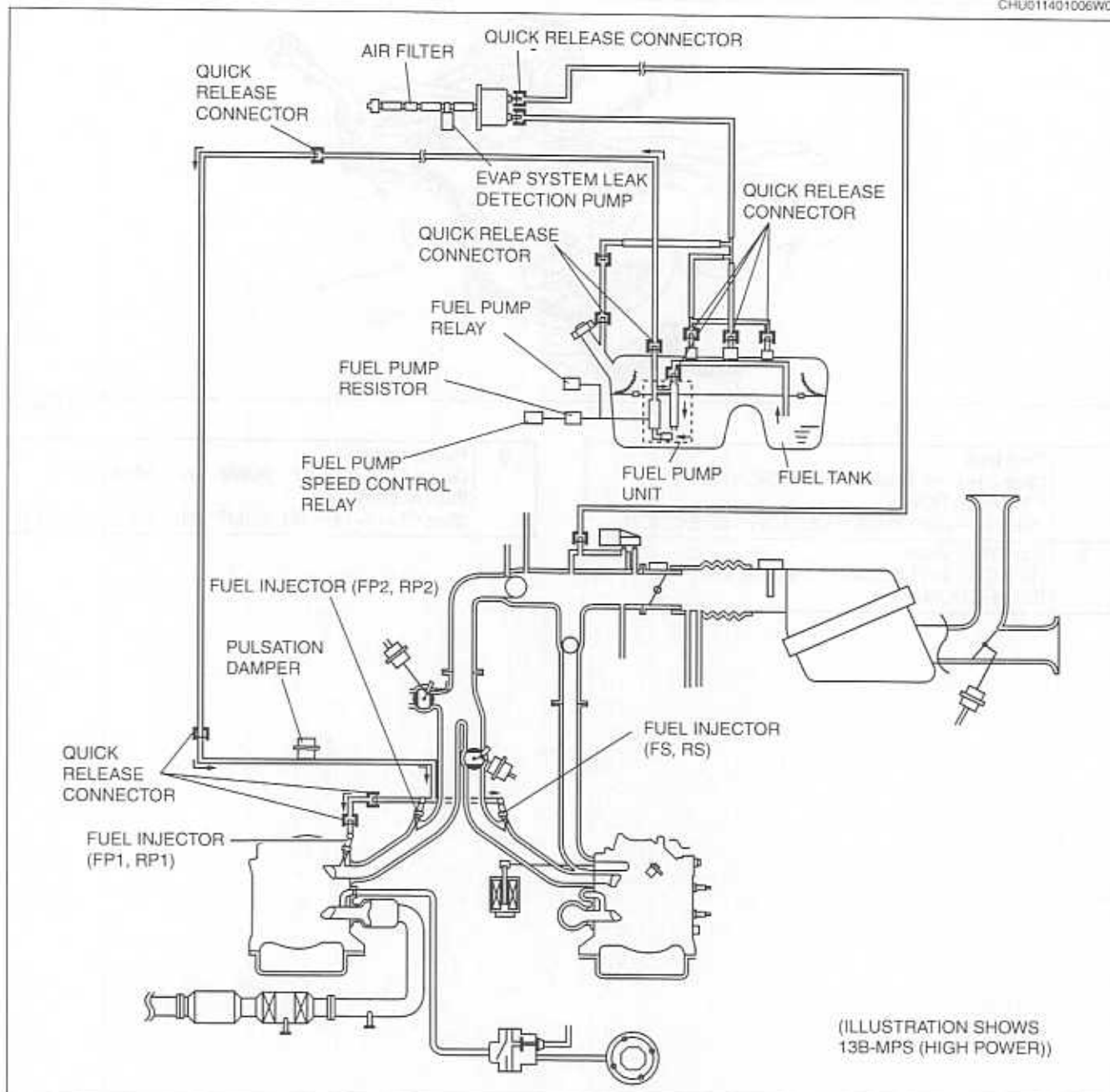

CHU01145003

BEFORE REPAIR PROCEDURE

CHU011401006W03

Warning

- Fuel is extremely flammable. Always keep sparks and flame away from fuel. Ignition may cause death or serious injury, or damage to equipment.
- Fuel line spills and leakage from the pressurized fuel system are dangerous. Fuel can ignite and cause serious injury or death and damage. Fuel can also irritate skin and eyes. To prevent this, always complete the "Fuel Line Safety Procedure".

Caution

- If there is foreign material on the connecting area of the quick release connector, it might damage the connector or fuel pipe. To prevent this, when the quick release connector has been disconnected, clean the connecting area before reconnecting it.