



MOUNTING BRACKET KIT INSTALLATION INSTRUCTIONS

KIT NO. 727-3

10/08/04

RV

ROADMASTER, Inc. 5602 N.E. Skyport Way Portland, OR 97218 1-800-669-9690 Fax (503) 288-8900 www.roadmasterinc.com

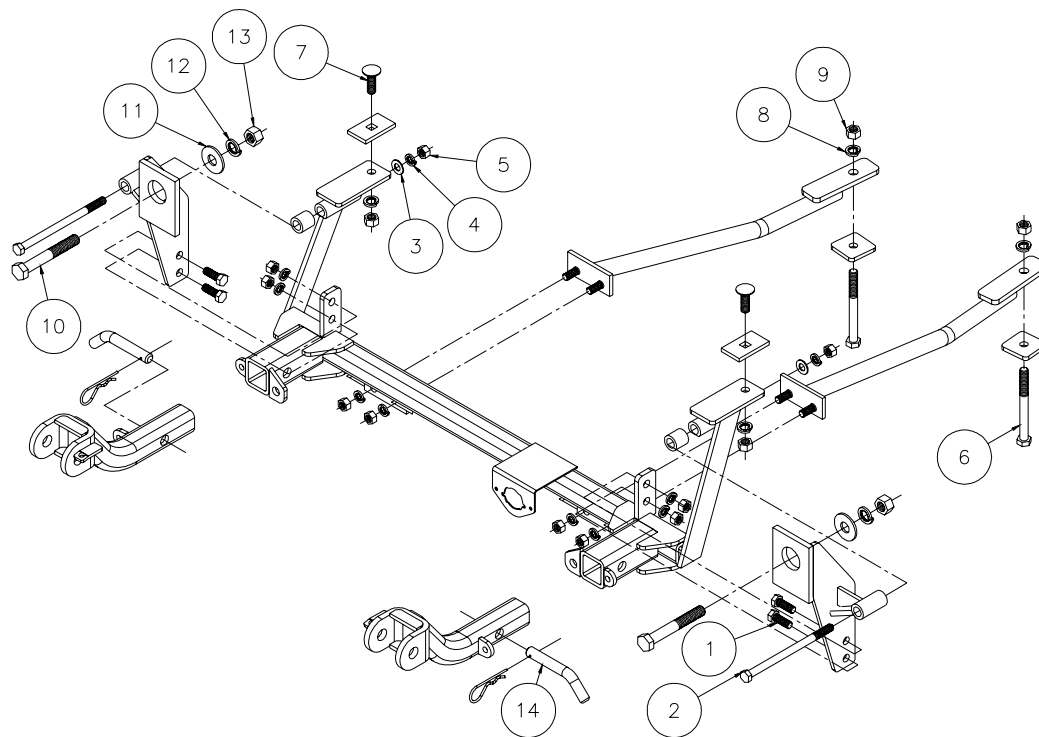

Item #	Qty.	Length	Width	Description
1	8	1 1/4"	7/16"	7/16" x 1 1/4" BOLT
2	2	7"	7/16"	7/16" x 7" BOLT
3	2		7/16"	FLATWASHER
4	10		7/16"	LOCKWASHER
5	10		7/16"	NUT
6	2	5"	1/2"	1/2" x 5" BOLT
7	2	1 1/2"	1/2"	1/2" x 1 1/2" CARRIAGE BOLT
8	4		1/2"	LOCKWASHER
9	4		1/2"	NUT
10	2	4 1/2"	5/8"	5/8" x 4 1/2" BOLT
11	2		5/8"	FLATWASHER
12	2		5/8"	LOCKWASHER
13	2		5/8"	NUT
14	2		5/8"	DRAW PIN, SPRING PIN

ROADMASTER, INC.



MOUNTING BRACKET KIT INSTALLATION INSTRUCTIONS

KIT NO. 727-3

10/08/04

RV

ROADMASTER, Inc. 5602 N.E. Skyport Way Portland, OR 97218 1-800-669-9690 Fax (503) 288-8900 www.roadmasterinc.com

IMPORTANT: All brackets **must** be assembled with all the bolts left loose for final adjustment & positioning (before tightening) unless otherwise instructed. All bolts **must** be torqued for proper strength. If more than one bolt is used per fastening point, the diagram may only show one.

- Use flat washers over all slotted holes
- Use lock washers on all fasteners

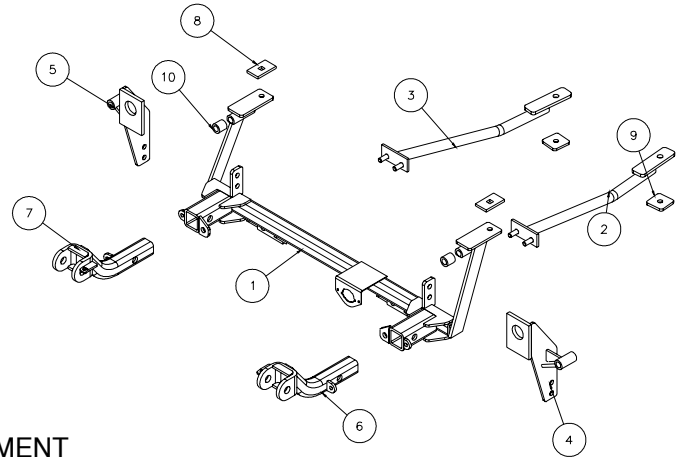

Item	Qty.	Part #	Description
1	1	C-001058	MAIN BRACE WELDMENT
2	1	C-001059	DRIVER SIDE REAR BRACE
3	1	C-001060	PASSENGER SIDE REAR BRACE
4	1	C-001061	DRIVER SIDE BUMPER CORE BRACE
5	1	C-001062	PASSENGER SIDE BUMPER CORE BRACE
6	1	C-001065	DRIVER SIDE ARM BRACE WELDMENT
7	1	C-001066	PASSENGER SIDE ARM BRACE WELDMENT
8	2	A-000084	BACKING PLATE - 1 1/2" x 2 1/2" - SQ. HOLE
9	2	A-000075	1/4" x 2" x 2" BACKING PLATE
10	2	A-001724	1" x 1" O.D. WITH CUT END

IMPORTANT – Limited 1-year warranty on materials and workmanship – Complete warranty enclosed.

WARNING:

- Do not use this document for custom fabrication, as it may not show all parts or structural components.
- Roadmaster will not be responsible for any damage or injury resulting from any modification or alteration.
- The owner must inspect all mounts and brackets before each use for cracks or other signs of fatigue. Also, inspect the fasteners for proper torque, according to the torque chart.
- The installer must read the instructions and use all bolts and parts supplied.
- Minor modifications are sometimes necessary due to slight vehicle variations, even for the same year, make and model.
- If the towed vehicle has been in an accident, it must be properly repaired before attaching the brackets. Do not install the brackets if any structural frame damage is found. Failure to repair the damage may result in loss of your towed vehicle.
- The driver must not back up the motorhome with the towed vehicle attached, or non-warranty damage will occur to your towing system or towed vehicle.

- The safety cables must connect the towing vehicle to the towed vehicle frame to frame, with the cables crossed. Refer to the cable instructions for proper routing.
- Make sure there is enough slack in the safety cables at the motorhome to allow for sharp turns.
- Some motorhome chassis have such a tight turning radius that you can damage your motorhome, towed vehicle or tow bar while turning sharply. Before getting on the road, test your turning radius in an empty parking lot. Damage that results from turning too sharply is not covered by warranty.
- Use caution when operating the tow bar to be sure that your hands, fingers or any part of your body does not get caught between moving components, resulting in injury.
- This bracket is designed for use with Roadmaster tow bars and Roadmaster adaptors. Using this bracket with other brands, without an approved Roadmaster adaptor, may result in non-warranty damage or injury.
- Important! This bracket is only warranted for the original installation. Installing a used bracket on another vehicle is not recommended and will void the warranty.
- Upon final installation, the installer must inspect the bracket to ensure adequate clearance, particularly around hoses, AC lines, radiators, etc., or non-warranty damage will result.

WARNING: Failure to follow these instructions can result in property damage, personal injury or even death.

ROADMASTER, INC.



MOUNTING BRACKET KIT INSTALLATION INSTRUCTIONS

KIT NO. 727-3

10/08/04

RV

ROADMASTER, Inc. 5602 N.E. Skyport Way Portland, OR 97218 1-800-669-9690 Fax (503) 288-8900 www.roadmasterinc.com

1. This is one of our MX series brackets, which is hidden, for the most part, behind the front bumper fascia and the grill (Fig.A). The bracket consists of a main receiver brace, upper braces, rear braces, front braces and a hardware pack. Before starting the installation, lay out the kit components as illustrated. This will give you a visual idea of how the components work and also confirm that everything is present and accounted for.



2. Start by removing the six plastic retainers from the core support cover and remove (Fig.B).



(Fig.B)



(Fig.C)

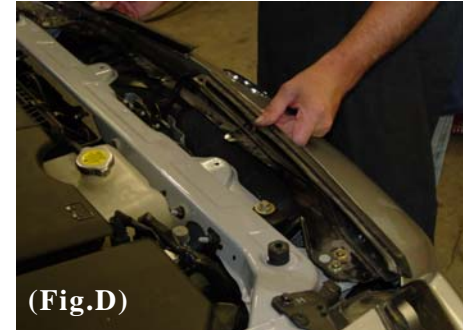

(Fig.D)

3. There are two plastic retainers and four 10mm head bolts connecting the fascia to the core support and remove the hood sealer retainers (Fig.C,D).

4. Now remove four plastic retainers from each fender liner (Fig.E), and ten 8mm bolts from the lower front fascia (Fig.F).



(Fig.E)



(Fig.F)



(Fig.G)

5. Pull away the fender liner in each wheel well and remove one 8mm bolt from each side (Fig.G).

6. Carefully pull the side of the fascia down and out on each side (Fig.H). Then from the center of the fascia lift up and pull out be sure to disconnect the fog lights and turn signals before completely removing.(Fig.I,J).

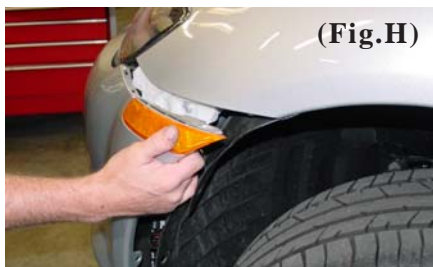

(Fig.H)



(Fig.I)

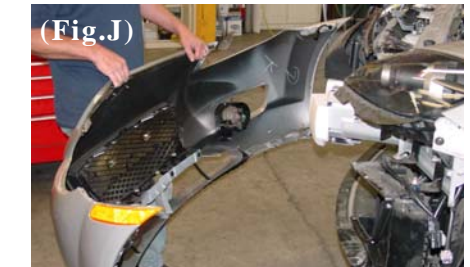

(Fig.J)



MOUNTING BRACKET KIT INSTALLATION INSTRUCTIONS

KIT NO. 727-3

10/08/04

RV

ROADMASTER, Inc. 5602 N.E. Skyport Way Portland, OR 97218 1-800-669-9690 Fax (503) 288-8900 www.roadmasterinc.com



(Fig.K)



(Fig.L)

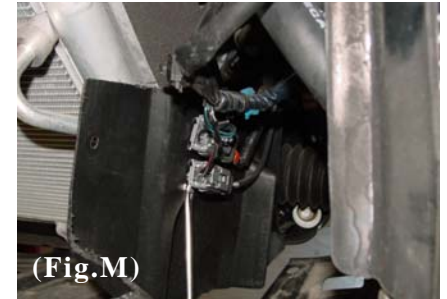

(Fig.M)

7. Remove six plastic retainers and two 10mm bolts from the center of the splash panel (Fig.K). Also remove the two 10mm head bolts and the one plastic fastener from each side holding the center splash panel to the frame rail (Fig.L).

8. Be sure to remove 10 electrical plug retainers from the center splash panel and then remove the splash panel (Fig.M).



(Fig.N)



(Fig.O)



(Fig.P)

9. Remove four 10mm bolts from the center fascia support, two plastic fasteners and then remove the support (Fig.N,O).

10. Remove eight plastic fasteners from the air intake support (Fig.P).

11. Remove four core support bolts from each side and remove the core support (Fig.Q,R).

12. Remove one 10mm bolt holding the oil cool line bracket on each side and bend the tab on the bracket down (Fig.S,T,U).

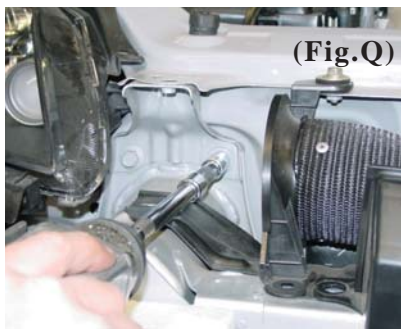

(Fig.Q)



(Fig.R)



(Fig.S)



MOUNTING BRACKET KIT INSTALLATION INSTRUCTIONS

KIT NO. 727-3

10/08/04

RV

ROADMASTER, Inc. 5602 N.E. Skyport Way Portland, OR 97218 1-800-669-9690 Fax (503) 288-8900 www.roadmasterinc.com



(Fig.T)



(Fig.U)

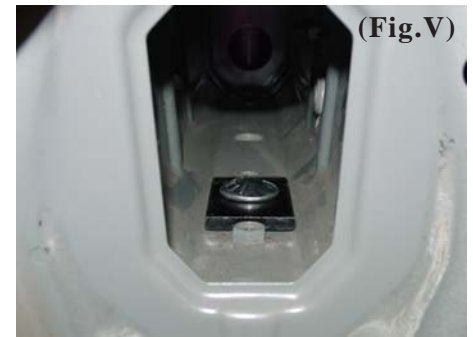

(Fig.V)

13. Insert a 1/2" x 1 1/2" carriage bolt and one 1/2" x 1 1/2" square hole backing plate thru the existing hole behind the core support, on each side (Fig.V).

14. Place the main receiver brace in place and using the carriage bolt placed in the last step bolt thru the rear hole using a lock washer and nut (Fig.W,X).

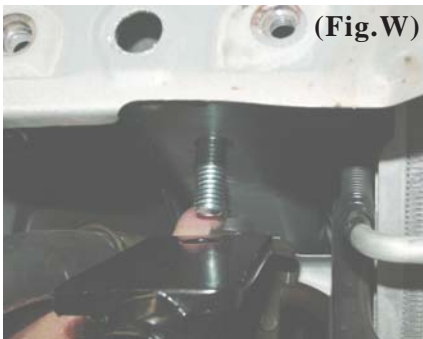

(Fig.W)



(Fig.X)

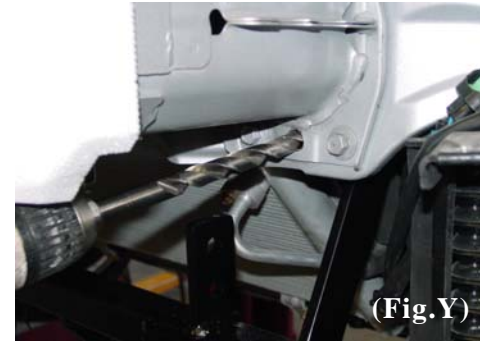

(Fig.Y)

15. Now reinstall the bumper core.

16. Enlarge the existing hole with a 1/2" drill bit (Fig.Y).

17. Place the driver side upper brace and bolt thru the bumper core and into the brace with a 5/8" x 4 1/2" bolt, flat washer, lock washer and nut (Fig.Z)

18. Bolt the upper brace to the main brace using two 7/16" x 1 1/4" bolt, lock washers, and nuts (Fig.AA).

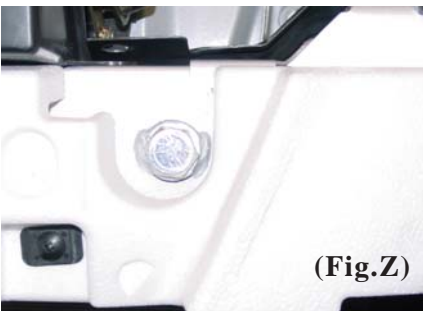

(Fig.Z)

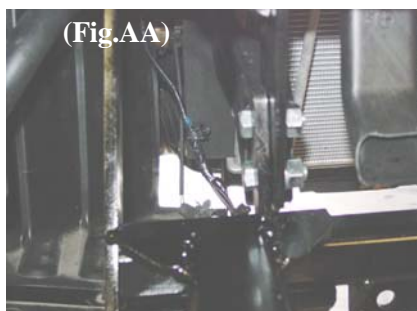

(Fig.AA)

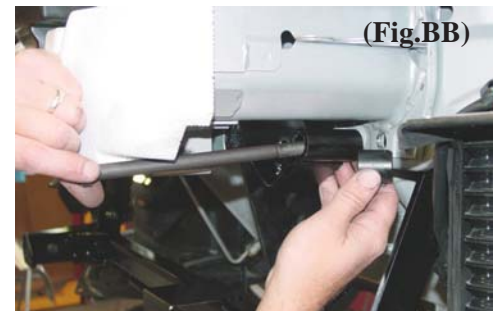

(Fig.BB)

19. Repeat steps 17 and 18 on the passenger side.

20. Now place the 1" x 1" spacer and bolt thru the main brace and into the bumper core with a 7/16" x 7" bolt, lock washer and nut on both sides (Fig.BB).



MOUNTING BRACKET KIT INSTALLATION INSTRUCTIONS

KIT NO. 727-3

10/08/04

RV

ROADMASTER, Inc. 5602 N.E. Skyport Way Portland, OR 97218 1-800-669-9690 Fax (503) 288-8900 www.roadmasterinc.com

ROADMASTER, INC.



(Fig.CC)



(Fig.DD)

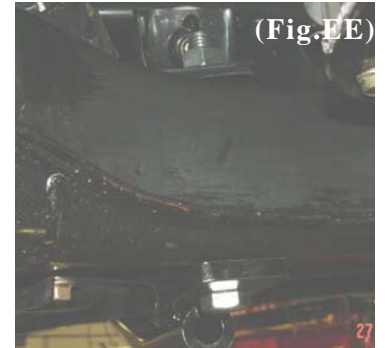

(Fig.EE)

21. Install the rear braces with a 7/16" lock washer and nut (Fig.CC). Enlarge the existing hole shown in (Fig.DD) with a 1/2" drill bit and then bolt the rear of the brace with a 1/2" x 5" bolt, 2" x 2" backing plate, lock washer and nut (Fig.EE).

22. Trim the center splash panel to fit around the braces as shown (Fig.FF,GG).

23. Reverse steps 1 through 10 to reinstall the fascia.

24. Install the front braces in the receiver tubes and pin in place with 5/8" draw pins and spring pins



(Fig.FF)

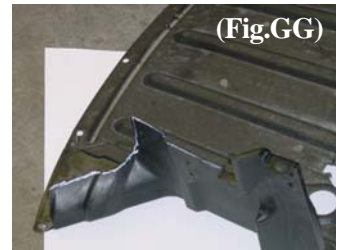

(Fig.GG)

25. Install the tow bar according to the manufacturer's instructions and torque all mounting bolts to the specifications below.

BOLT TORQUE REQUIREMENTS

STANDARD BOLTS

SIZE	GRADE	TORQUE
5/16	5	13 ft./lb.
3/8	5	23 ft./lb.
7/16	5	37 ft./lb.
1/2	5	56 ft./lb.
5/8	5	150 ft./lb.

METRIC BOLTS

SIZE	GRADE	PLATED / UNPLATED
M 8-1.0	8.8	20 ft./lb. 18ft./lb.
M 8-1.25	8.8	19 ft./lb. 18ft./lb.
M 10-1.25	8.8	38 ft./lb. 36ft./lb.
M 10-1.5	8.8	37 ft./lb. 35ft./lb.

METRIC BOLTS

SIZE	GRADE	PLATED / UNPLATED
M 12-1.25	8.8	70 ft./lb. 65ft./lb.
M 12-1.5	8.8	66 ft./lb. 61ft./lb.
M 12-1.75	8.8	65 ft./lb. 60ft./lb.
M 14- 2.0	8.8	104 ft./lb. 97ft./lb.

All illustrations and specifications contained herein are based on the latest information available at the time of publication approval. ROADMASTER, INC. reserves the right to make changes at any time without notice in material, specification and models or to discontinue models.