

**2003-07 MAZDA6, 2006-07 MAZDASPEED6, 2004-08 RX-8, 2004-05 MPV, 2004 B-SERIES TRUCK - AIR BAG SAFETY RECALL 7914J**
**RECALL NOTE**

- The REPAIR PROCEDURE was revised on 11/5/14.
- Changes are noted below in red beside the change bar.

**A. VEHICLE INSPECTION PROCEDURE**

1. Verify that the vehicle is within the following ranges:

Model	VIN Range	Build Date Range
2003-2007 Mazda6	1YVFP8***35 M16528 - M57051	From January 17, 2003 through April 17, 2007
	1YVFP8***45 N07463 - N99292	
	1YVFP8***55 M01113 - M76942	
	1YVFP8***65 M00408 - M59667	
	1YVHP8***35 M16533 - M54148	
	1YVHP8***45 N07480 - N99243	
	1YVHP8***55 M00054 - M77517	
	1YVHP8***65 M00086 - M63629	
	1YVHP8***75 M38074 - M55181	
2006-2007 Mazdaspeed6	JM1GG1***61 100091 - 108029	From August 18, 2005 through June 28, 2007
	JM1GG1***71 108061 - 110732	
2004-2008 RX-8	JM1FE1***40 100063 - 140879	From April 10, 2003 through July 4, 2007
	JM1FE1***50 140895 - 161156	
	JM1FE1***60 200013 - 207444	
	JM1FE1***70 207473 - 214011	
	JM1FE1***80 214012 - 214178	
2004-2005 MPV	JM3LW2***40 500023 - 531782	From August 21, 2003 through August 18, 2004
	JM3LW2***50 531899 - 532952	
2004 B-Series	4F4YR12**4T M00089 - M12957	From August 11, 2003 through February 19, 2004
	4F4YR16**4T M00023 - M13004	
	4F4YR17**4T M01807 - M12717	
	4F4YR46**4T M00276 - M11764	
	4F4YR47**4T M00075 - M03517	
	4F4ZR16**4T M00472 - M12580	
	4F4ZR17**4T M01789 - M12709	
	4F4ZR47**4T M04732 - M12624	

- If the vehicle is within the above ranges, proceed to Step 2.
- If the vehicle is not within the above ranges, return vehicle to the customer or inventory.

2. Perform a Warranty Vehicle Inquiry using your eMDCS System and inspect vehicle for Campaign Labels **Recall 7914J** attached to the vehicle’s hood or bulkhead. Refer to eMDCS System - Warranty Vehicle Inquiry Results table below.

**NOTE:** Be sure to verify Recall number as the vehicle may have multiple Recall labels.

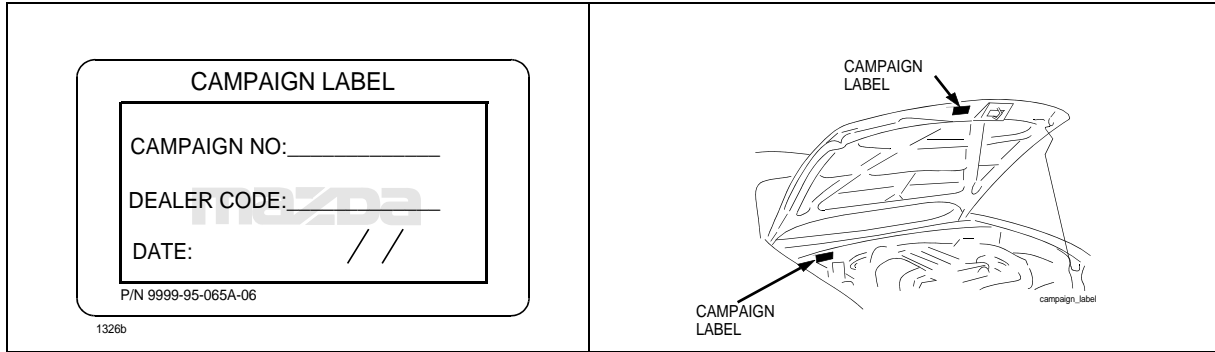

**eMDCS System - Warranty Vehicle Inquiry Results:**

<b>If eMDCS displays:</b>	<b>Campaign Label is:</b>	<b>Action to perform:</b>
RECALL 7914J OPEN	Present	Contact the Warranty Hotline at (877) 727-6626 option 3 to update vehicle history.
	Not present	Proceed to “B. REPAIR PROCEDURE”.
RECALL 7914J CLOSED	Present	Return vehicle to inventory or customer.
	Not present	Proceed to “C. CAMPAIGN LABEL INSTALLATION”.
RECALL 7914J is not displayed	Does not apply	Recall does not apply to this vehicle. Return vehicle to inventory or customer.

**B. REPAIR PROCEDURE**

<b>Year / Model</b>	<b>Airbag Inflator</b>	<b>Page No.</b>
2003-2005 Mazda6	Passenger side	3
2004-2005 RX-8	Passenger side	10
2004-2005 MPV	Passenger side	18
2004 B-Series	Passenger side	25
2004-2007 Mazda6, 2006-2007 Mazdaspeed6, 2004-2008 RX-8	Driver side	33

2003-2005 Mazda6:

Passenger-Side Air Bag Inflator Replacement Procedure:

Parts Information: The service parts are available in one box [Inflator (A), Stopper Plate (B), and 4 Nuts (C)].

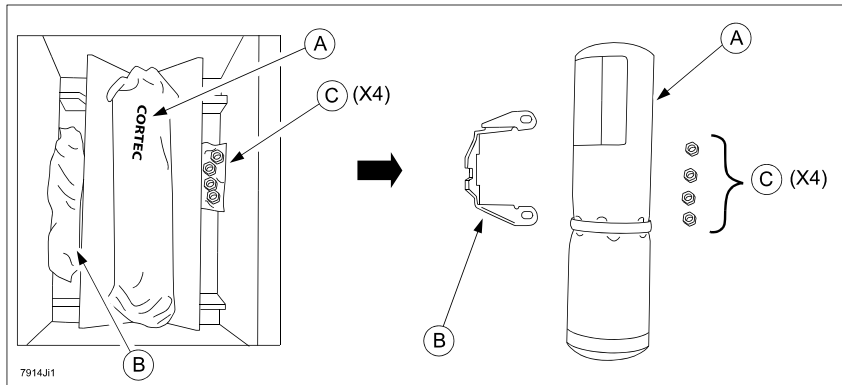

Outline:

1. Remove the inflator from the passenger-side air bag module (A), then replace it with a modified one (B) identified with a yellow stripe (C).

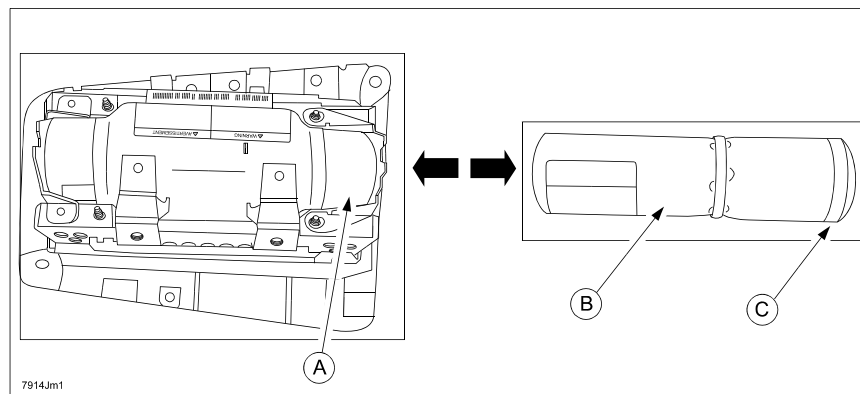

2. Pack and return the removed inflator as follows:

**IMPORTANT: Be sure to follow the packing and shipping instructions provided in the carton and in Attachment IV, Air Bag Inflator Return Instructions.**

**CAUTION:**

- Use the same carton which was used to deliver a new inflator. It is a specialized box that is internationally accepted for shipping an inflator.
- Pack the old inflator in the box exactly in the same manner as the new inflator was packed.

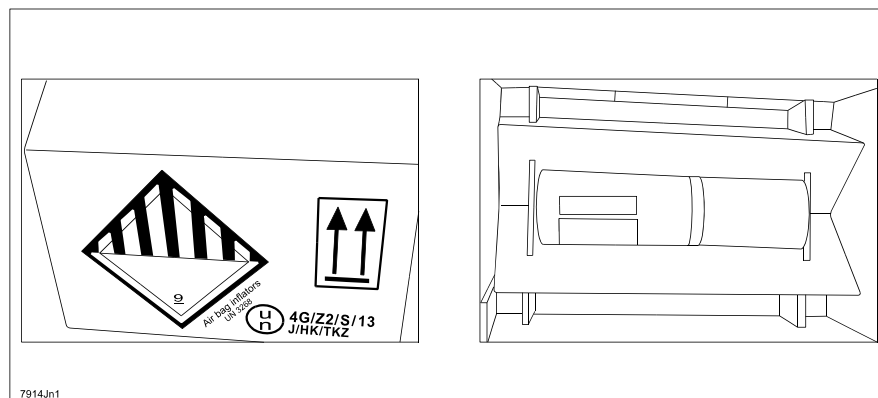

**Air Bag Module Removal:**

**WARNING:**

- Perform the replacement in a clean environment. Oil, grease, water, etc. on components may cause the air bag modules to fail to deploy in an accident, which may cause serious injury. Do not allow oil, grease, water, etc., on components.
- Inserting a screwdriver, etc., into the connector of an air bag module may damage the connector and cause the air bag module to deploy improperly, which may cause serious injury. Do not insert any foreign objects into the connector.
- Do not disassemble the vehicle, other than instructed here.
- Do not make an attempt to directly supply electrical power to the module and the inflator.
- Keep the module facing of the pad surface upwards at all times, except during replacement.
- Do not use the module and new inflator if they were dropped on the ground.
- Avoid module and inflator exposure to temperatures of 194 degrees F (90 degrees C) or more.

1. Turn the ignition switch to the LOCK position.
2. Record the customer's preset radio stations.
3. Disconnect the negative battery cable and wait for one (1) minute or more.
4. Remove the glove compartment.
  - a. Detach the string from the glove compartment.

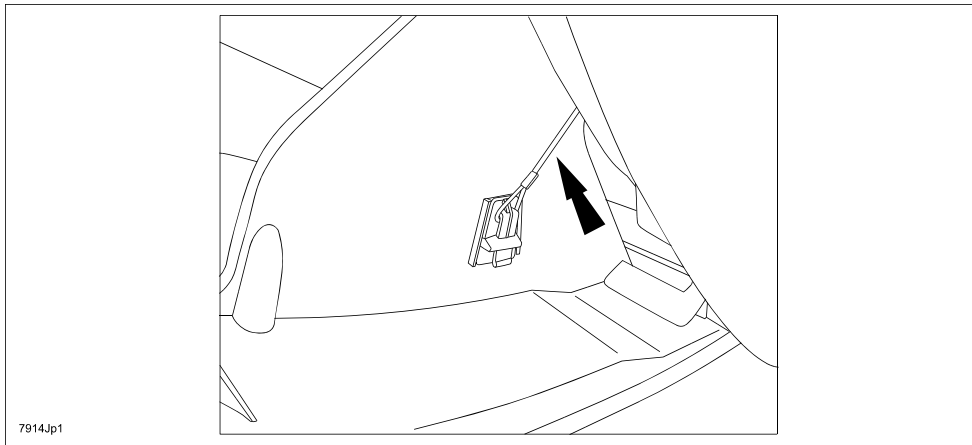

- b. Press the glove compartment stoppers (A) inward.
- c. Lower the glove compartment (B) downward and pull the clips (C) to remove it.

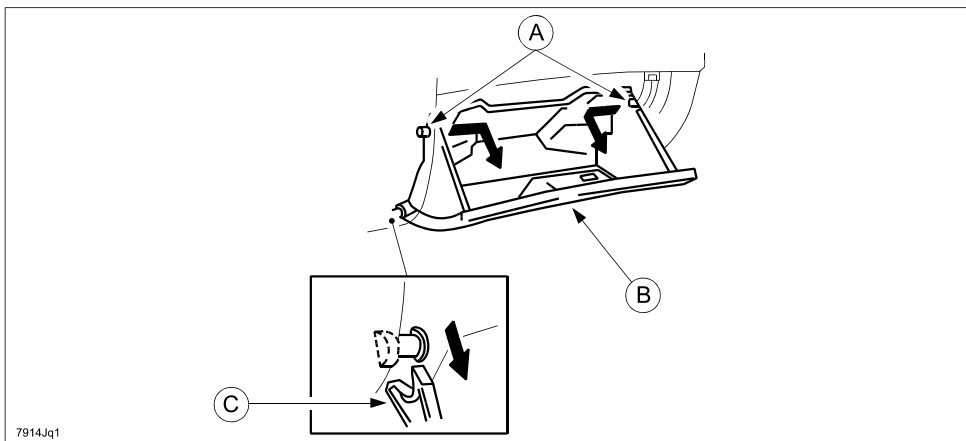

5. Remove the navigation unit (if equipped).
  - a. Remove the bolts.
  - b. Remove the navigation unit.

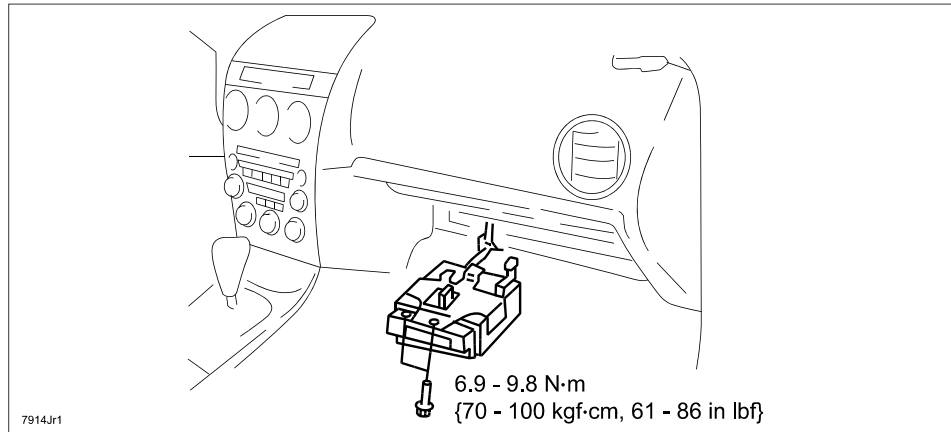

6. Remove the air bag module.

**CAUTION:**

- Be careful when prying out the stopper plate. Otherwise, damage to the stopper plate could occur. Or if it pops off and is lost, it is not available as a separate part.
- The stopper plate must be pryed up before disconnecting the connector. Otherwise, the connector could be damaged if trying to disconnect it with the stopper plate engaged.
- Use extreme care when disconnecting the connector. Otherwise, damage to the connector could occur.

- a. Using a flathead screwdriver, gently pry out the connector stopper plate.
- b. Disconnect the connectors (A).

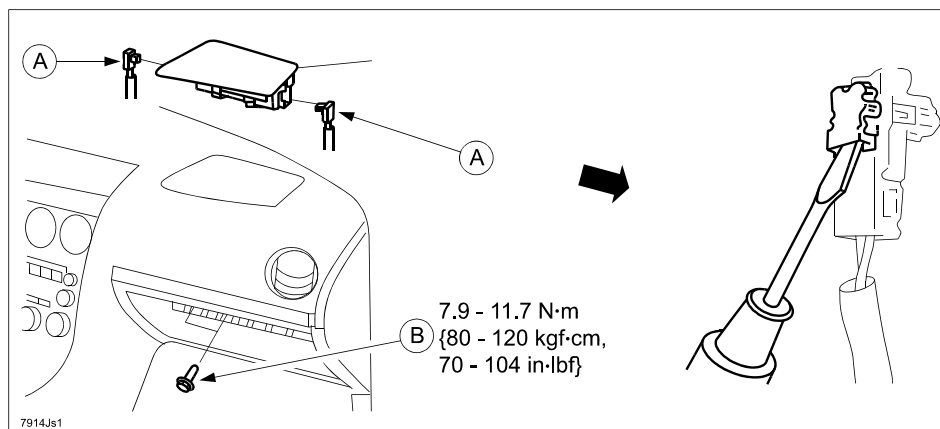

- c. Remove the bolt (B).
7. Lay a protective cloth on the work bench, then place the air bag module on it to avoid any damage or scratches to the surface.

**Inflator Replacement:**

1. Loosen four (4) nuts until the upper surface of the nuts are aligned with the top edge of the screw thread. For easier inflator removal, depress the four (4) nuts and make a gap between the inflator and air bag module.

**NOTE:** Do not depress excessively as the module body may detach.

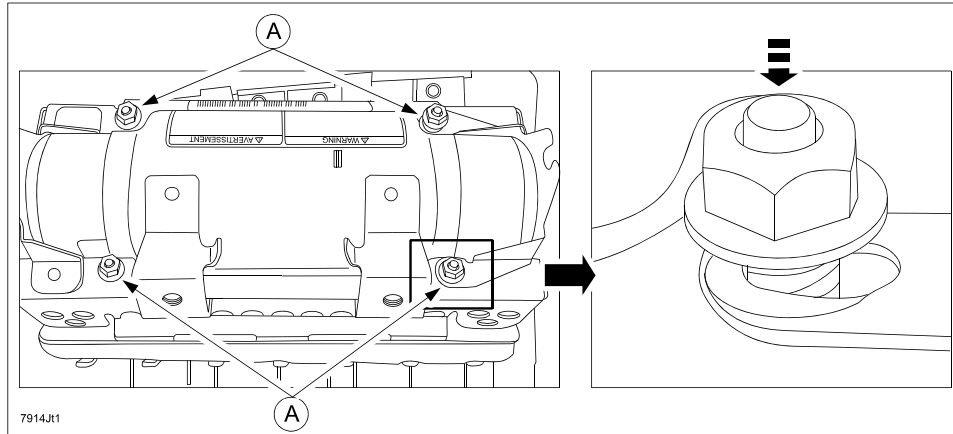

2. Remove the four (4) nuts, then remove the stopper plate from the air bag module.

**NOTE:** Discard all of the nuts and stopper plate.

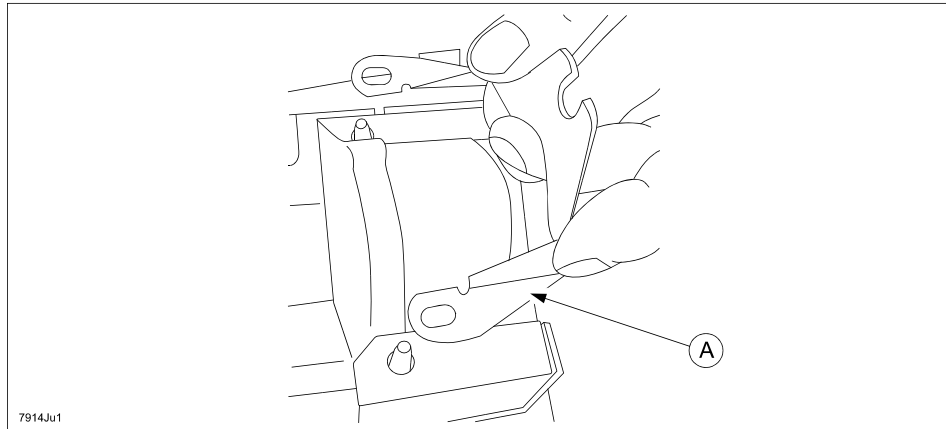

3. Push the inflator end with fingers, then remove it by sliding it in the direction shown below.

**IMPORTANT:** Return the removed inflator in the same carton in which the new part was received. Carefully follow the packing and shipping instructions included in the carton.

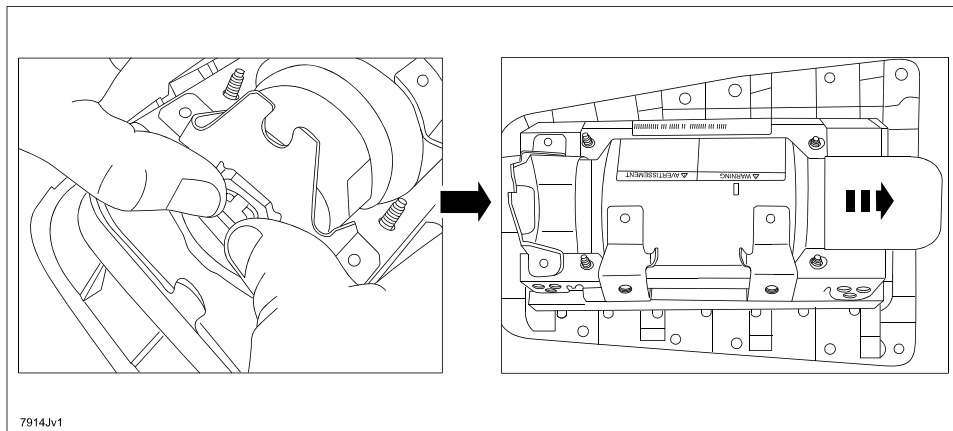

4. Insert the modified inflator from the opposite side of where the yellow identification tape (A) is located.

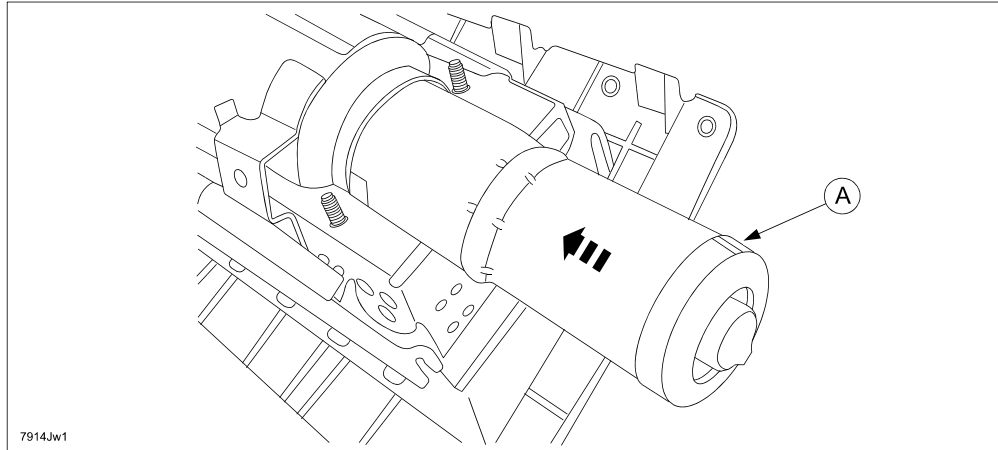

5. Insert the inflator up to the position where it touches the stopper (A), aligning the D-shape end of the inflator with the stopper opening (B).

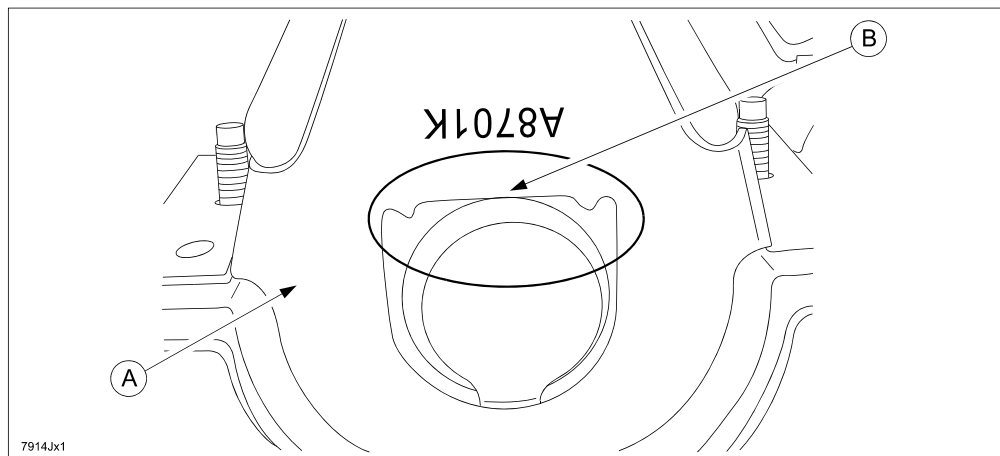

6. Set the new stopper plate (A) by gently pushing until it touches with the inflator side (B).

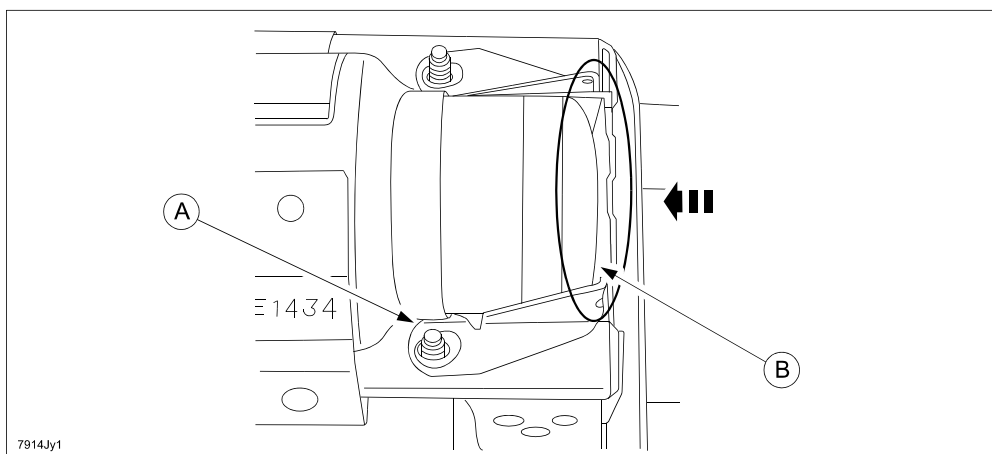

7. Keeping the position above, hand tighten the four (4) new nuts.
8. Tighten the four (4) new nuts to the specified torque in the order shown below (1, 2, 3, 4).  
**Tightening Torque: 35 +/- 1.8 in-lbf. {39.8 +/- 2.0 kgf-cm, 3.9 +/- 0.4 Nm}**

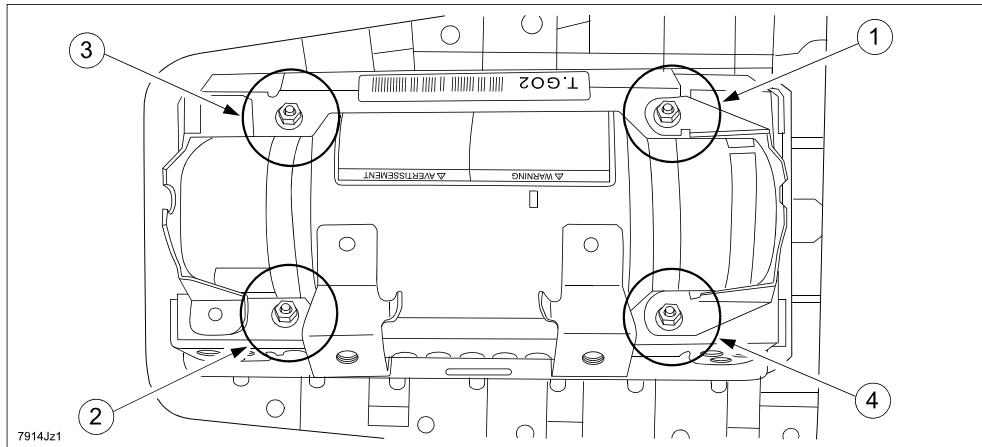

9. Remove the seal (A) from the end of the inflator on both sides.

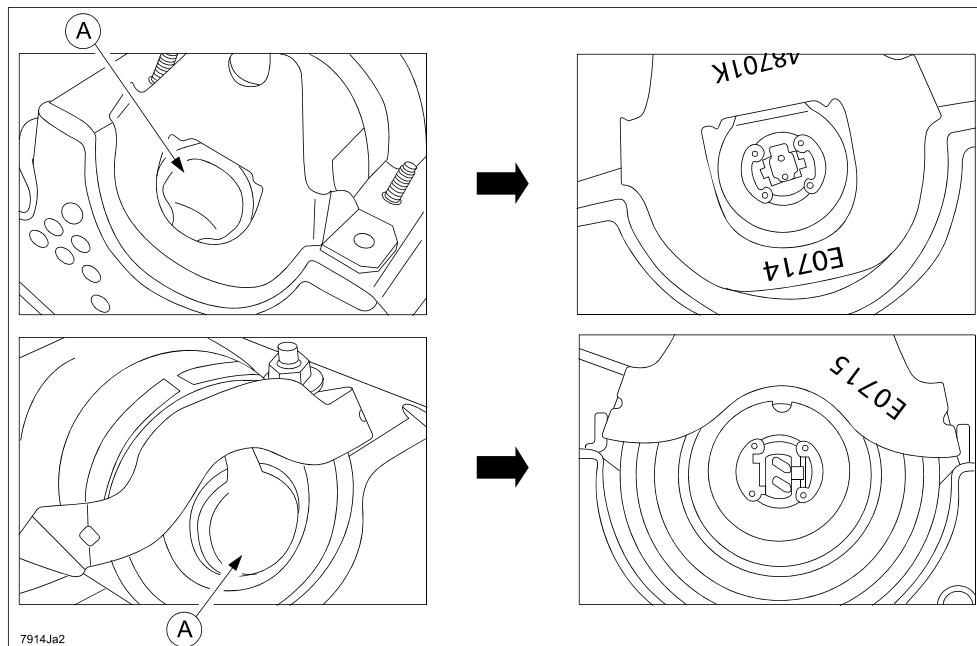



**Air Bag Module Reinstallation:**

1. Install the air bag module assembly.
2. Tighten the bolt (A) to the specified torque.  
**Tightening Torque: 70 - 104 in-lbf. {80 - 120 kgf-cm, 7.9 - 11.7 Nm}**

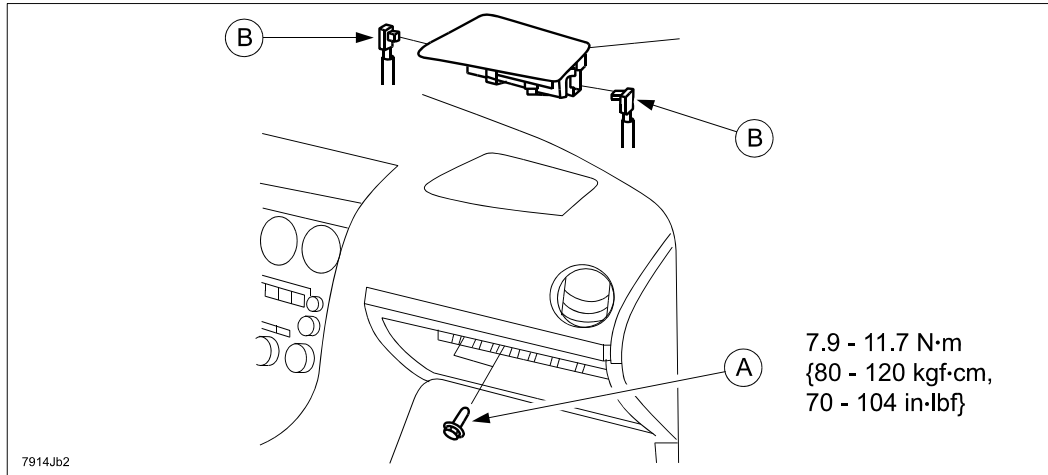

3. Re-connect the connectors (B) to air bag module.
4. Securely lock the connectors by depressing the stoppers (A) on the back of the connector.

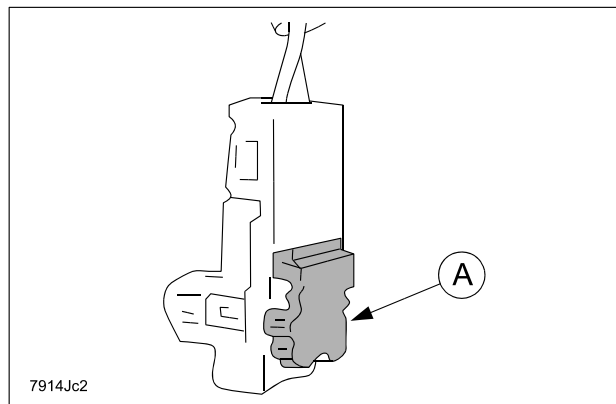

5. Reconnect the negative battery cable.
6. Turn the ignition switch to the ON position.
7. Verify that the air bag system warning light illuminates for approx. 6 sec., then goes out.

**NOTE:** If the air bag system warning light does not operate in the manner described above, there is a malfunction in the system. Inspect the system following the on-board diagnostic system procedure according to MS3 online or the Workshop Manual (section 08 Restraints).

8. Reinstall the navigation unit (if equipped).
9. Reinstall the glove box.
10. Re-enter the customer's preset radio stations.
11. Proceed to "C. CAMPAIGN LABEL INSTALLATION".

2004-2005 RX-8:

**Passenger-Side Air Bag Inflator Replacement Procedure:**

Parts Information: The service parts are available in one box [Stopper plate (A), Inflator (B), and 4 Nuts (C)].

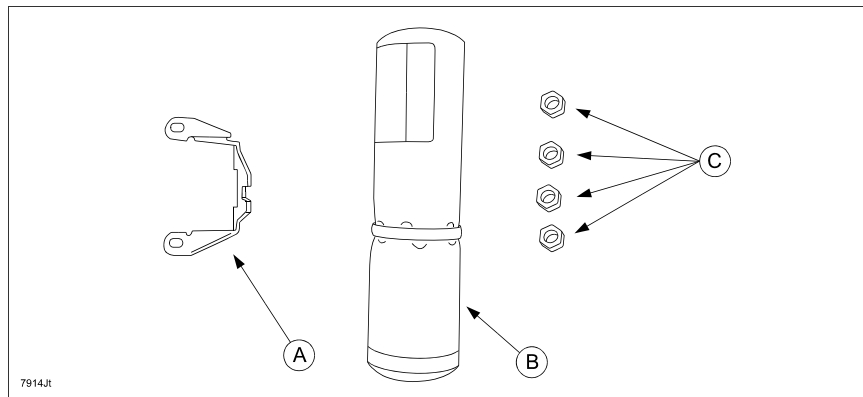

**Outline:**

1. Remove the inflator from the passenger-side air bag module (A), then replace it with a modified one (B) identified with a yellow stripe (C).

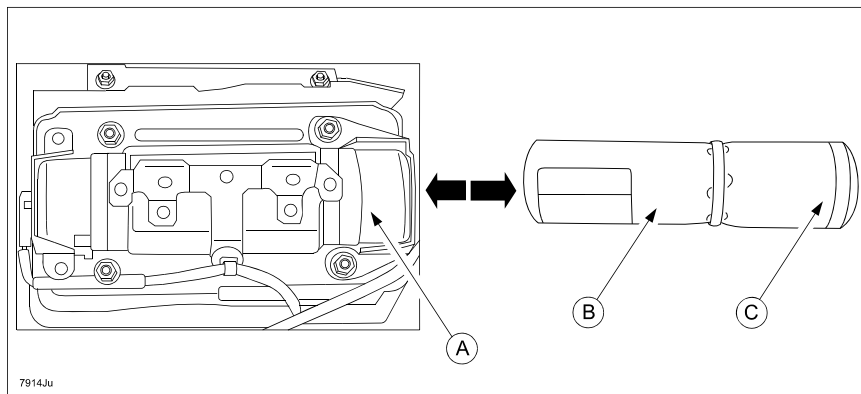

2. Pack and return the removed inflator as follows:

**IMPORTANT:** Be sure to follow the packing and shipping instructions provided in the carton and in Attachment IV, Air Bag Inflator Return Instructions.

**CAUTION:**

- Use the same carton which was used to deliver a new inflator. It is a specialized box that is internationally accepted for shipping an inflator.
- Pack the old inflator in the box exactly in the same manner as the new inflator was packed.

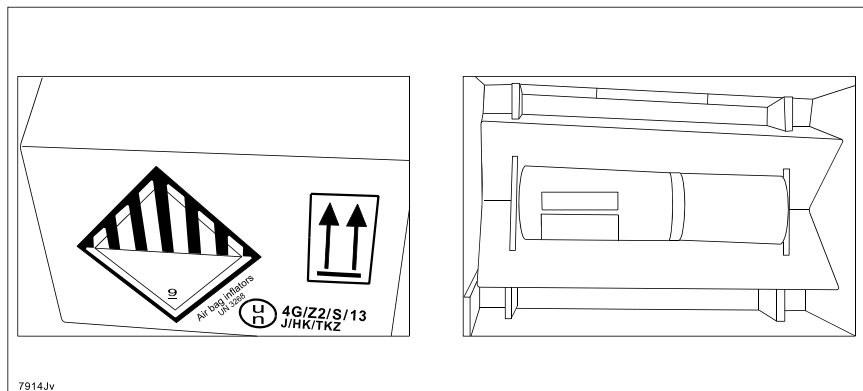

**Air Bag Module Removal:****WARNING:**

- Perform the replacement in a clean environment. Oil, grease, water, etc. on components may cause the air bag modules to fail to deploy in an accident, which may cause serious injury. Do not allow oil, grease, water, etc., on components.
  - Inserting a screwdriver, etc., into the connector of an air bag module may damage the connector and cause the air bag module to deploy improperly, which may cause serious injury. Do not insert any foreign objects into the connector.
  - Do not disassemble the vehicle, other than instructed here.
  - Do not make an attempt to directly supply electrical power to the module and the inflator.
  - Keep the module facing of the pad surface upwards at all times, except during replacement.
  - Do not use the module and new inflator if they were dropped on the ground.
  - Avoid module and inflator exposure to temperatures of 194 degrees F (90 degrees C) or more.
1. Turn the ignition switch to the LOCK position.
  2. Record the customer's preset radio stations.
  3. Disconnect the negative battery cable and wait for one (1) minute or more.
  4. Remove the glove compartment.
    - a. Pull the stay damper in the direction shown below.
    - b. Detach the glove compartment from the stay damper.

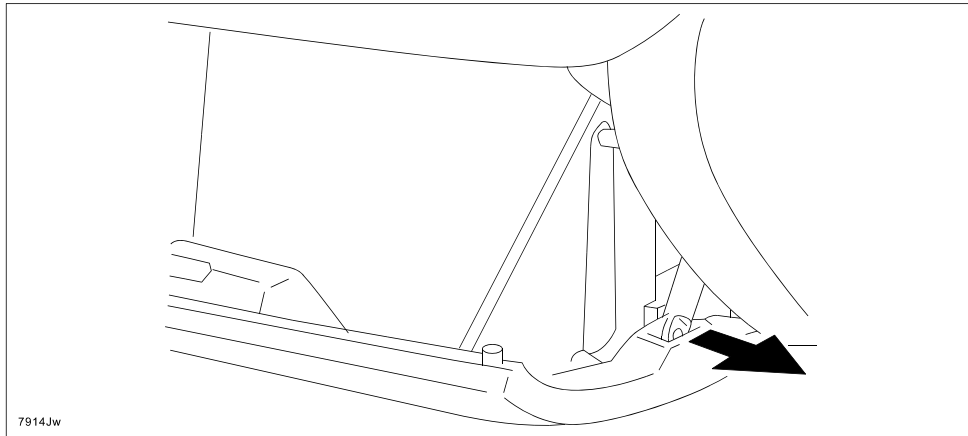

- c. Press the glove compartment stoppers inward.
- d. Lower the glove compartment downward.
- e. Detach the clips from the dashboard and remove the glove compartment.

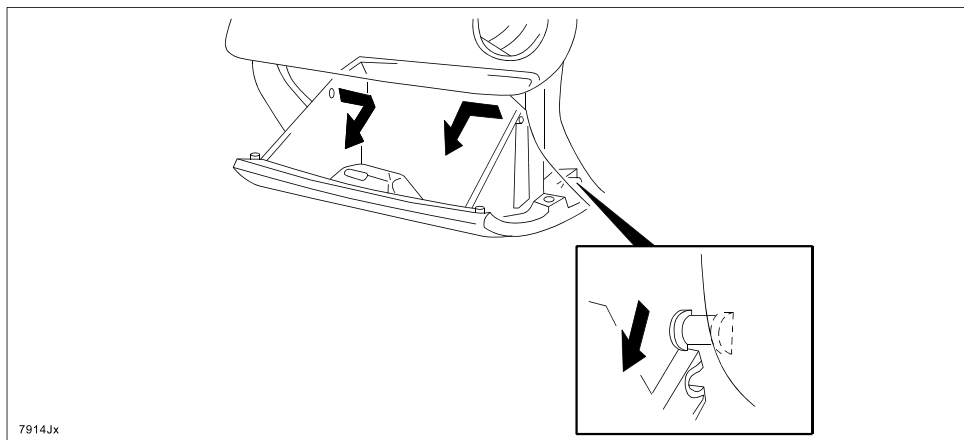

5. Remove the air bag module.
  - a. Remove the bolts (A).
  - b. Disconnect the connector (B).
  - c. Remove the air bag module (C).

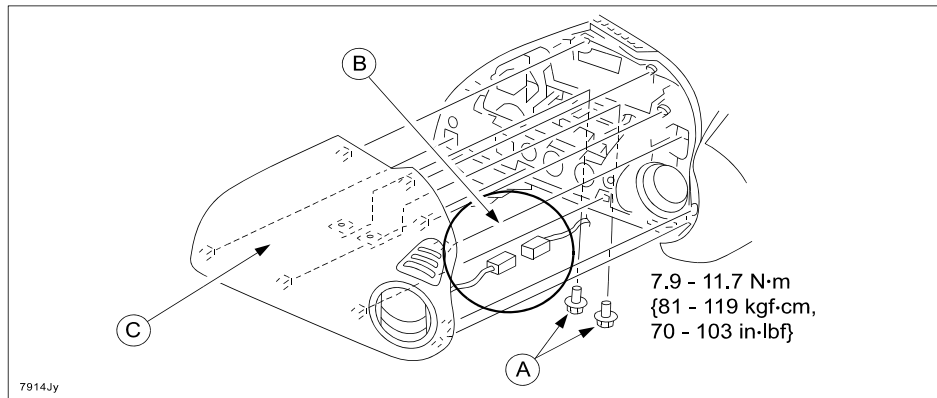

6. Lay a protective cloth on the work bench, then place the air bag module on it to avoid any damage or scratches to the surface.

**Inflator Replacement:**

1. Using a flathead screwdriver, pry out the connector stopper plate, then disconnect the connector (both sides).

**CAUTION:**

- Be careful when prying out the stopper plate. Otherwise, damage to the stopper plate could occur. Or if it pops off and is lost, it is not available as a separate part.
- The stopper plate must be pryed up before disconnecting the connector. Otherwise, the connector could be damaged if trying to disconnect it with the stopper plate engaged.
- Use extreme care when disconnecting the connector. Otherwise, damage to the connector could occur.

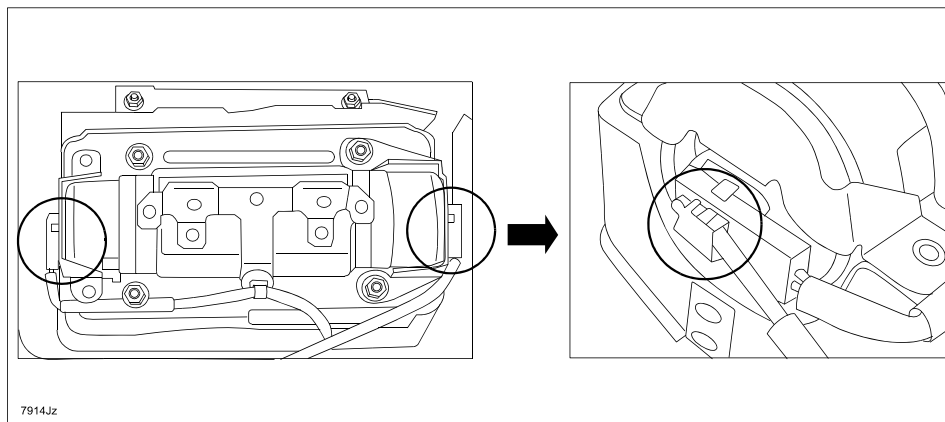

2. Loosen four (4) nuts until the upper surface of the nuts are aligned with the top edge of the screw thread.

- For easier inflator removal, depress the four (4) nuts and make a gap between the inflator and air bag module.

**NOTE:** Do not depress excessively as the module body may detach.

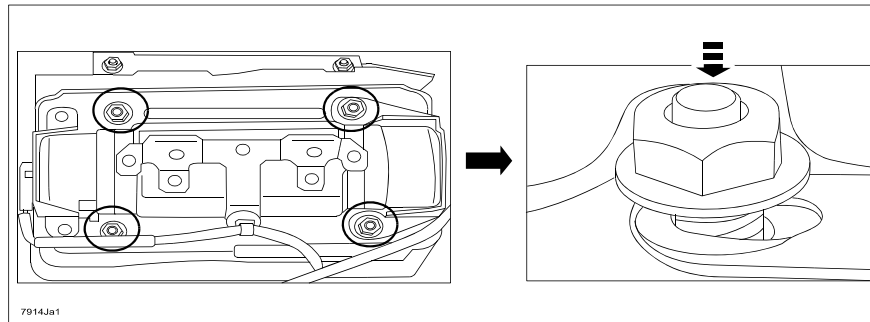

- Remove the four (4) nuts, then remove the stopper plate from the air bag module.

**NOTE:** Discard all of the nuts and stopper plate.

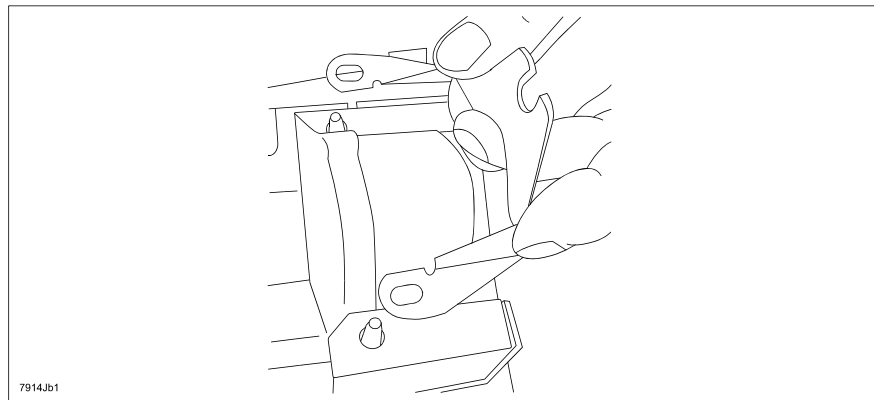

- Push the inflator end with fingers, then remove it by sliding it in the direction shown below.

**IMPORTANT:** Return the removed inflator in the same carton in which the new part was received. Carefully follow the packing and shipping instructions included in the carton.

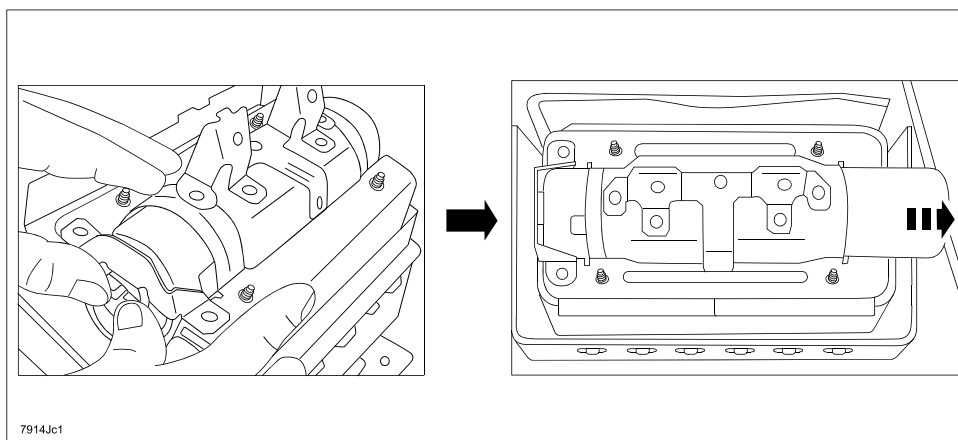

6. Insert the modified inflator from the opposite side of where the yellow identification tape (A) is located.

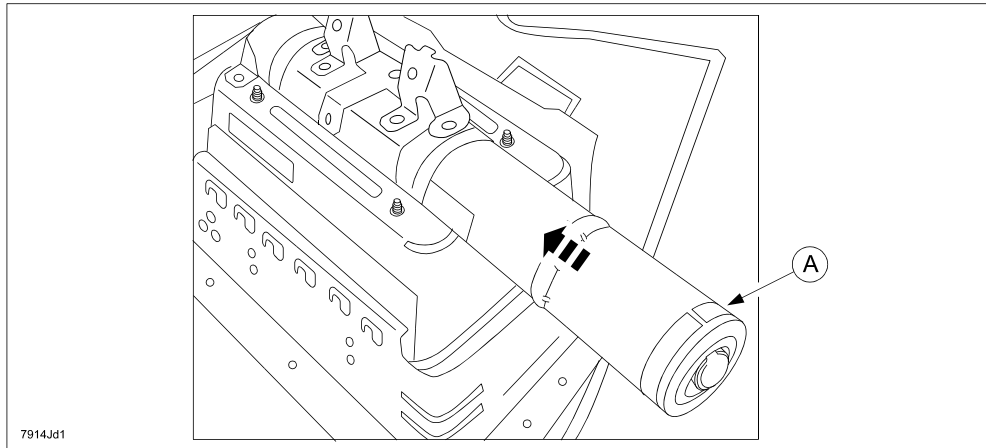

7. Insert the inflator up to the position where it touches the stopper (B), aligning the D-shape end of the inflator with the stopper opening (A).

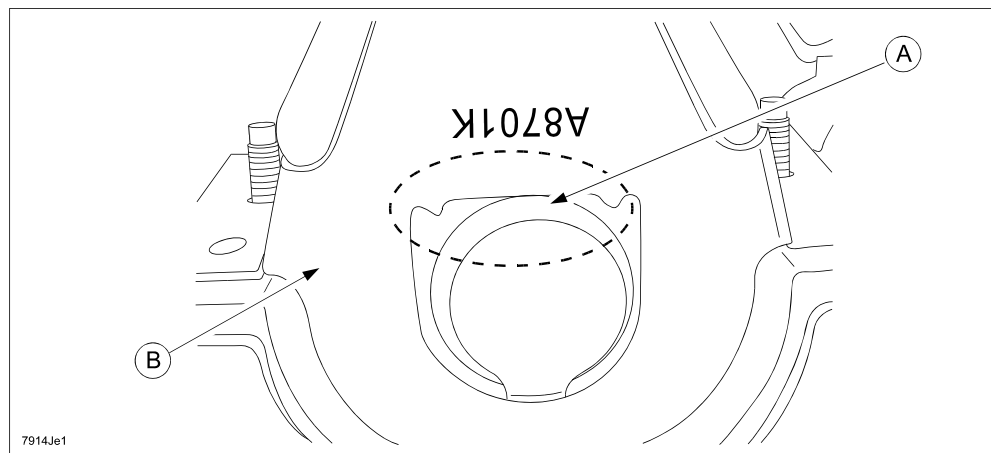

8. Set the new stopper plate (A) by gently pushing until it touches with the inflator side (B).

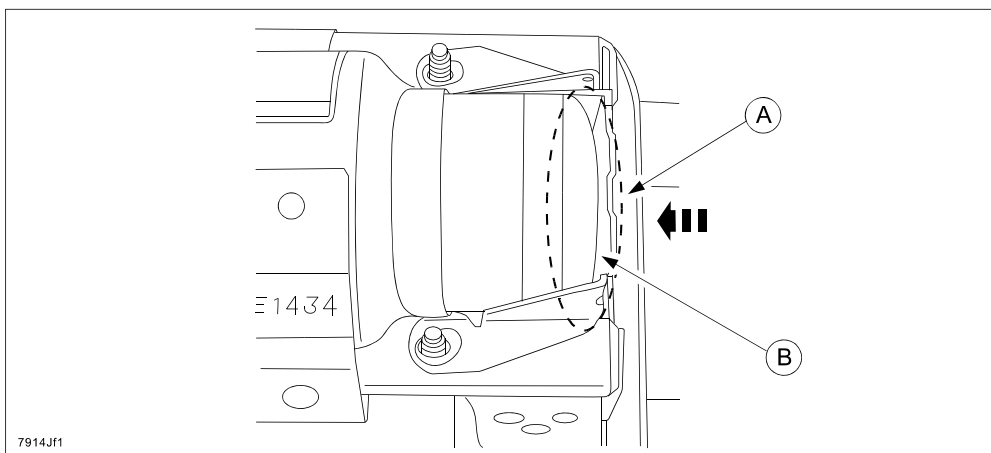

9. Keeping the position above, hand tighten the four (4) new nuts.

10. Tighten the four (4) new nuts to the specified torque in the order shown below (1, 2, 3, 4).  
**Tightening Torque: 35 +/- 1.8 in-lbf. {39.8 +/- 2.0 kgf-cm, 3.9 +/- 0.4 Nm}**

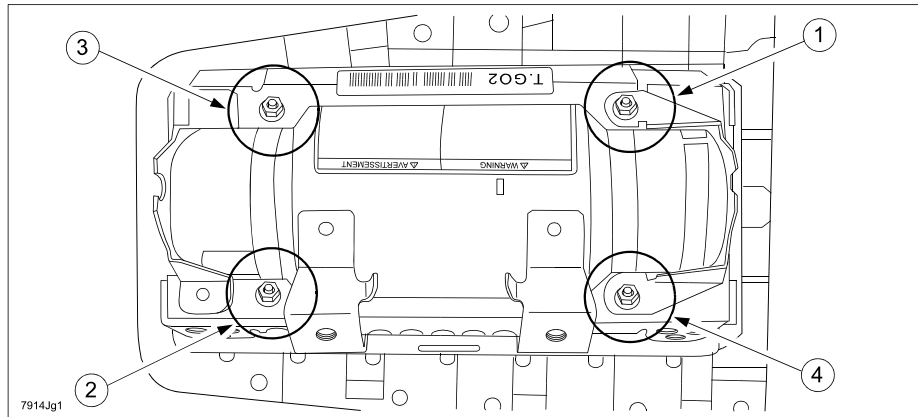

11. Remove the seal (A) from the end of the inflator on both sides.

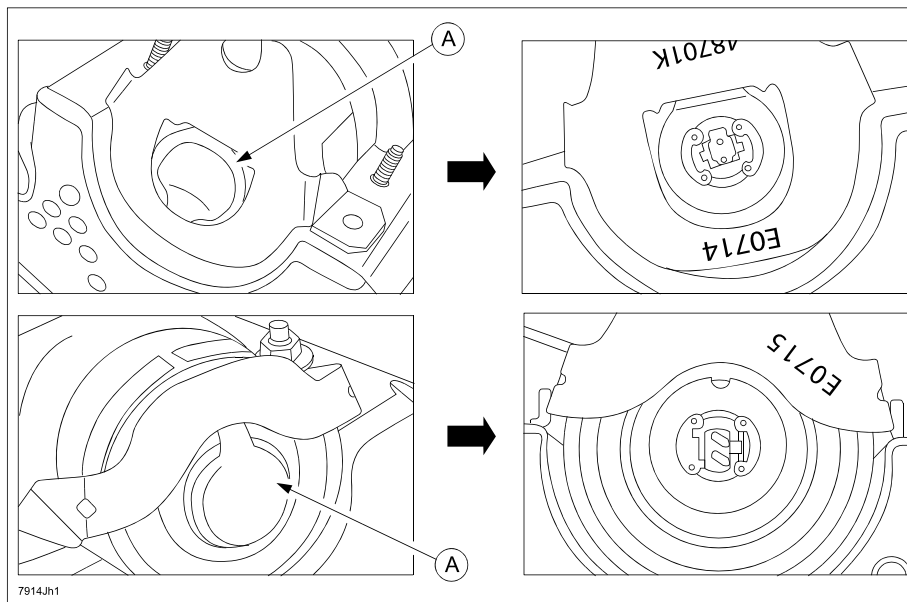

12. Install the new short harness to the inflator.

13. Securely lock the connectors by depressing the stoppers on the back of the connector (A).

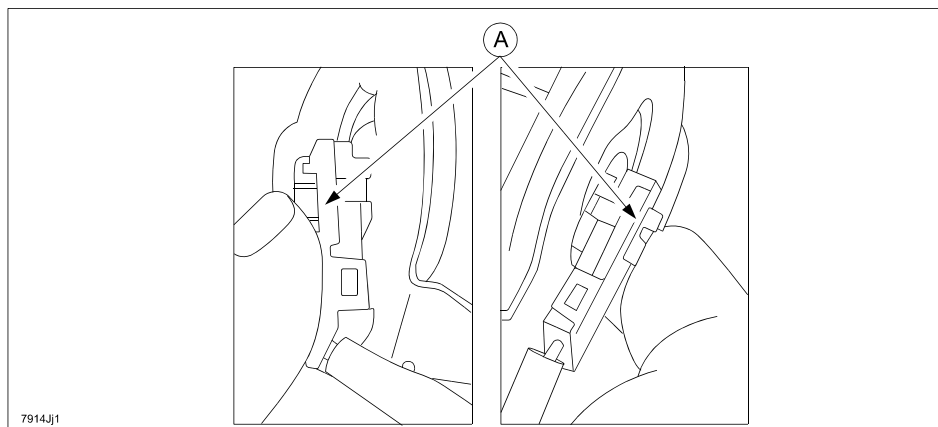

14. Verify that the clip of the harness (A) is securely fixed to the bracket.

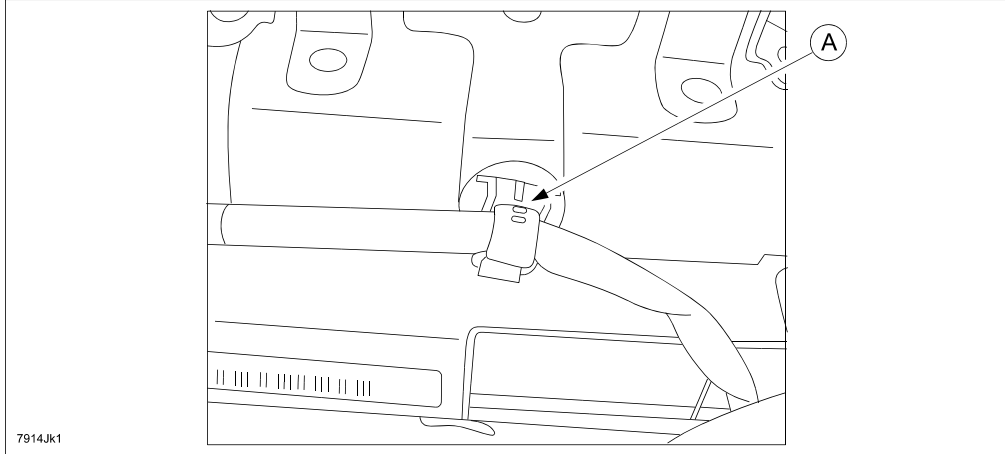



**Air Bag Module Reinstallation:**

1. Re-connect the connector (A), then install the air bag module (B) and the bolts (C).  
**Tightening Torque: 70 - 103 in-lbf. {81 - 119 kgf-cm, 7.9 - 11.7 Nm}**

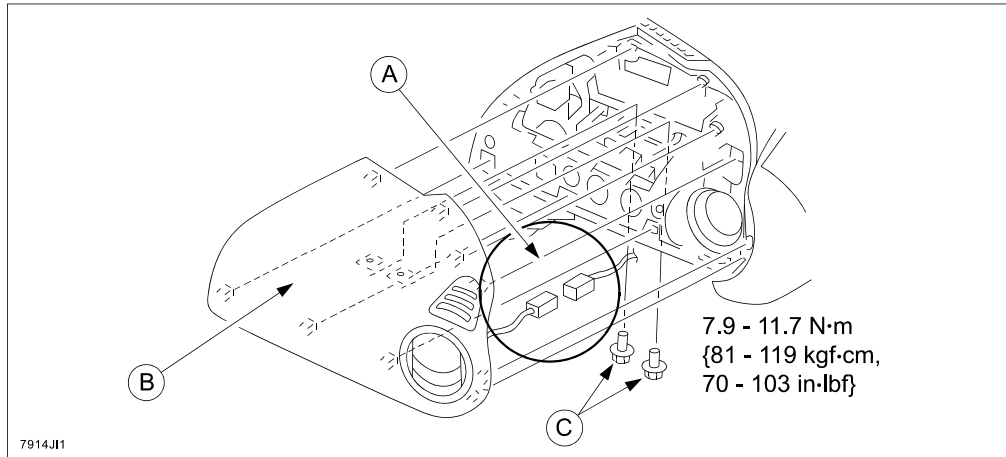

2. Reinstall the glove box.
3. Reconnect the negative battery cable.
4. Turn the ignition switch to the ON position.
5. Verify that the air bag system warning light illuminates for approx. 6 sec., then goes out.

**NOTE:** If the air bag system warning light does not operate in the manner described above, there is a malfunction in the system. Inspect the system following the on-board diagnostic system procedure according to MS3 online or the Workshop Manual (section 08 Restraints).

6. Re-enter the customer's preset radio stations.
7. Proceed to "C. CAMPAIGN LABEL INSTALLATION".

2004-2005 MPV:

**Passenger-Side Air Bag Inflator Replacement Procedure:**

Parts information: The service parts are available in one box [Stopper plate (A), Inflator (B), and 4 Nuts (C)]

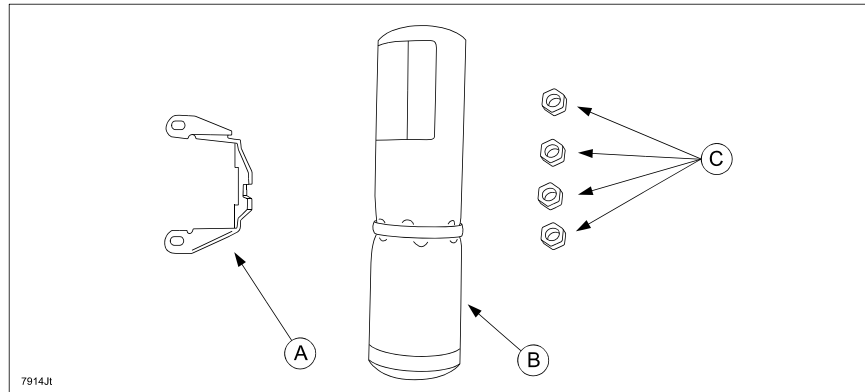

**Outline:**

1. Remove the inflator from the passenger-side air bag module (A), then replace it with a modified one (B) identified with a yellow stripe (C).

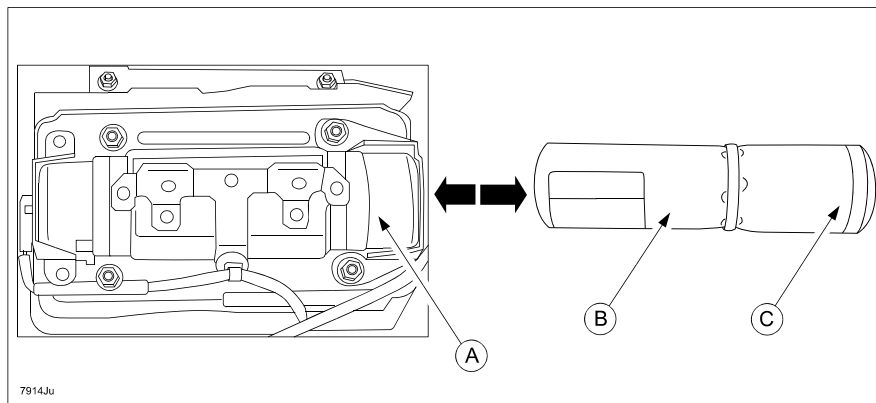

2. Pack and return the removed inflator as follows:

**IMPORTANT: Be sure to follow the packing and shipping instructions provided in the carton and in Attachment IV, Air Bag Inflator Return Instructions.**

**CAUTION:**

- Use the same carton which was used to deliver a new inflator. It is a specialized box that is internationally accepted for shipping an inflator.
- Pack the old inflator in the box exactly in the same manner as the new inflator was packed.

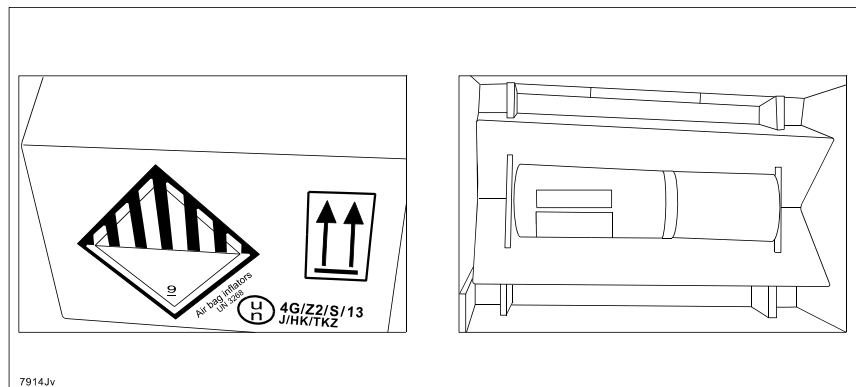

**Air Bag Module Removal:****WARNING:**

- Perform the replacement in a clean environment. Oil, grease, water, etc. on components may cause the air bag modules to fail to deploy in an accident, which may cause serious injury. Do not allow oil, grease, water, etc., on components.
  - Inserting a screwdriver, etc., into the connector of an air bag module may damage the connector and cause the air bag module to deploy improperly, which may cause serious injury. Do not insert any foreign objects into the connector.
  - Do not disassemble the vehicle, other than instructed here.
  - Do not make an attempt to directly supply electrical power to the module and the inflator.
  - Keep the module facing of the pad surface upwards at all times, except during replacement.
  - Do not use the module and new inflator if they were dropped on the ground.
  - Avoid module and inflator exposure to temperatures of 194 degrees F (90 degrees C) or more.
1. Turn the ignition switch to the LOCK position.
  2. Record the customer's preset radio stations.
  3. Disconnect the negative battery cable and wait for one (1) minute or more.
  4. Remove the glove compartment.
    - a. Bend the stoppers inward (A), then remove.

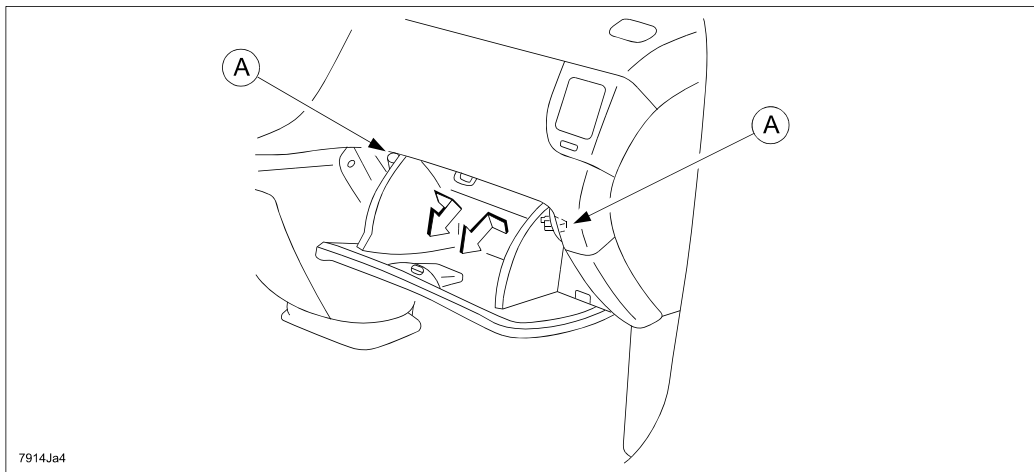

- b. Pull the glove compartment toward you while pushing it downward (1), then remove clip (A).
- c. Slide the glove compartment toward driver's side door (2).

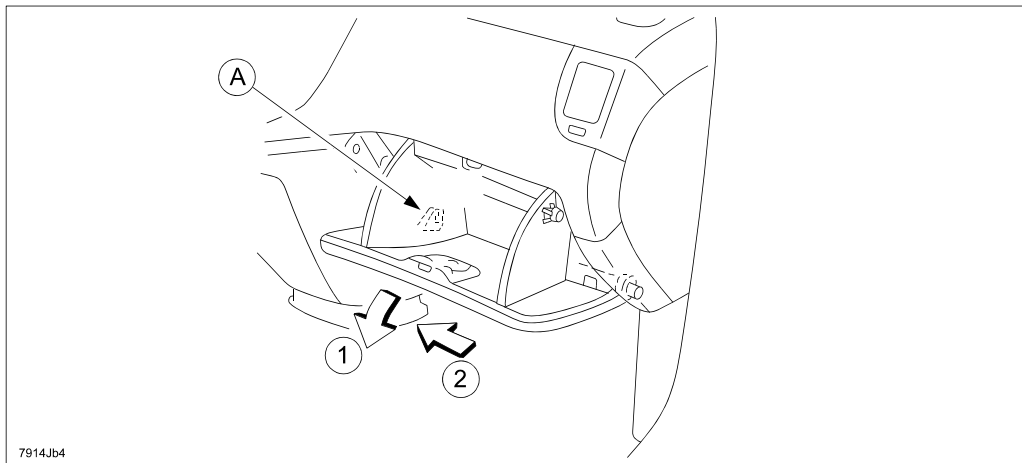

5. Remove the air bag module (A).
  - a. Disconnect the connector (B).
  - b. Remove the bolts (C).

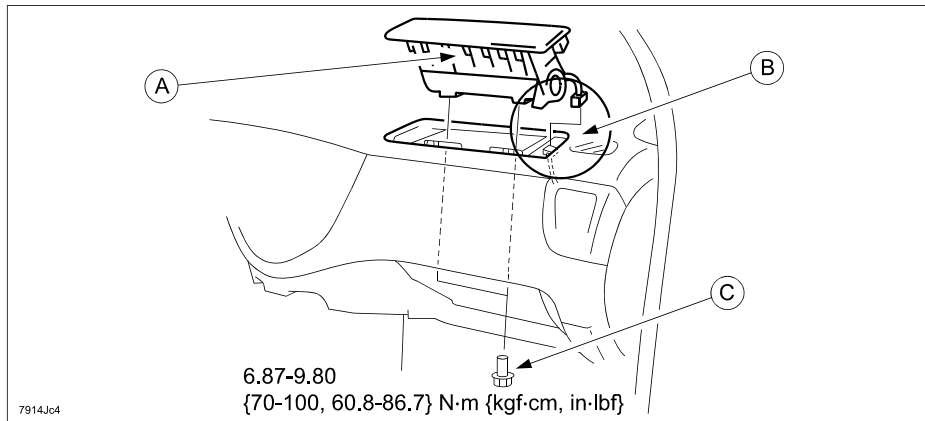

6. Lay a protective cloth on the work bench, then place the air bag module on it to avoid any damage or scratches to the surface.

**Inflator Replacement:**

1. Using a flathead screwdriver, pry out the connector stopper plate (A), then disconnect the connector.

**CAUTION:**

- Be careful when prying out the stopper plate. Otherwise, damage to the stopper plate could occur. Or if it pops off and is lost, it is not available as a separate part.
- The stopper plate must be pryed up before disconnecting the connector. Otherwise, the connector could be damaged if trying to disconnect it with the stopper plate engaged.
- Use extreme care when disconnecting the connector. Otherwise, damage to the connector could occur.

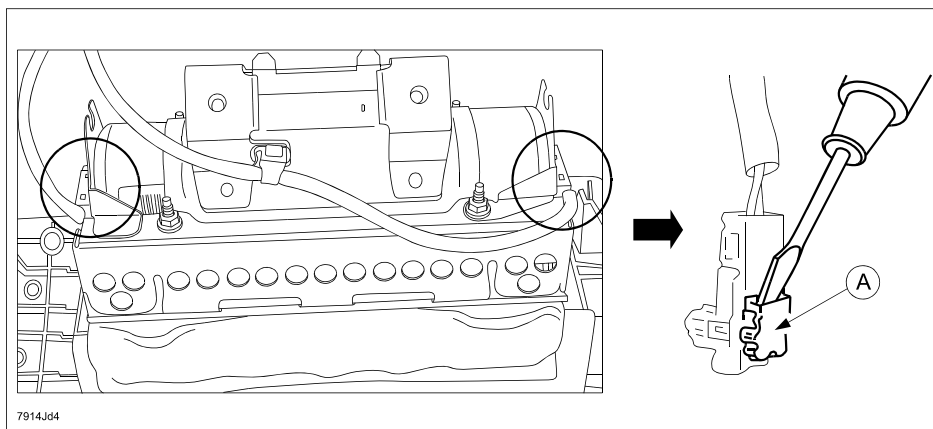

2. Loosen four (4) nuts until the upper surface of the nuts are aligned with the top edge of the screw thread.

- For easier inflator removal, depress the four (4) nuts and make a gap between the inflator and air bag module.

**NOTE:** Do not depress excessively as the module body may detach.

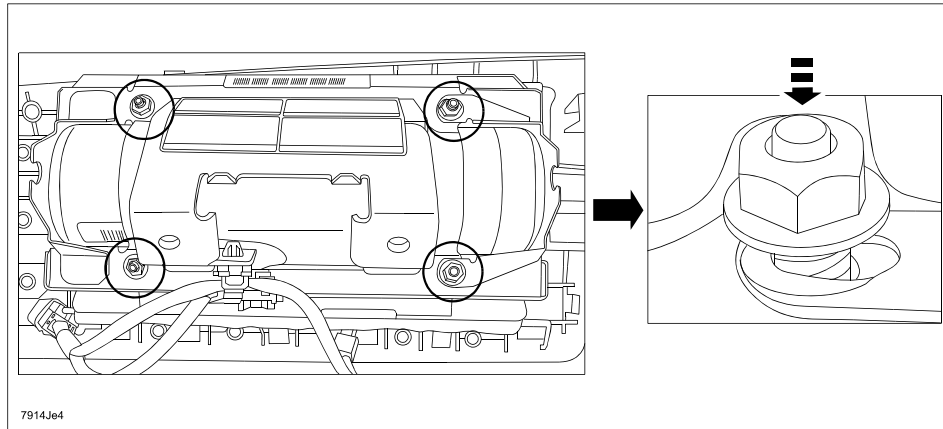

- Remove the four (4) nuts, then remove the stopper plate from the air bag module.

**NOTE:** Discard all of the nuts and stopper plate.

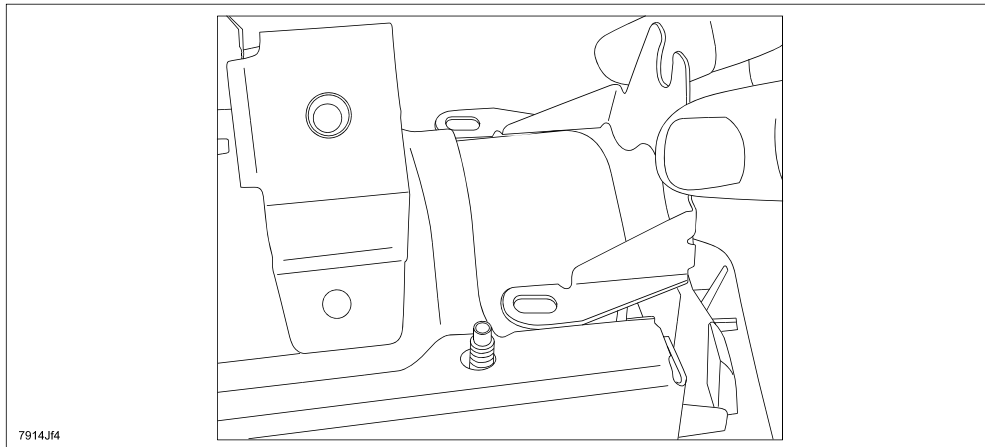

- Push the inflator end with fingers, then remove it by sliding it in the direction shown.

**IMPORTANT:** Return the removed inflator in the same carton in which the new part was received. Carefully follow the packing and shipping instructions included in the carton.

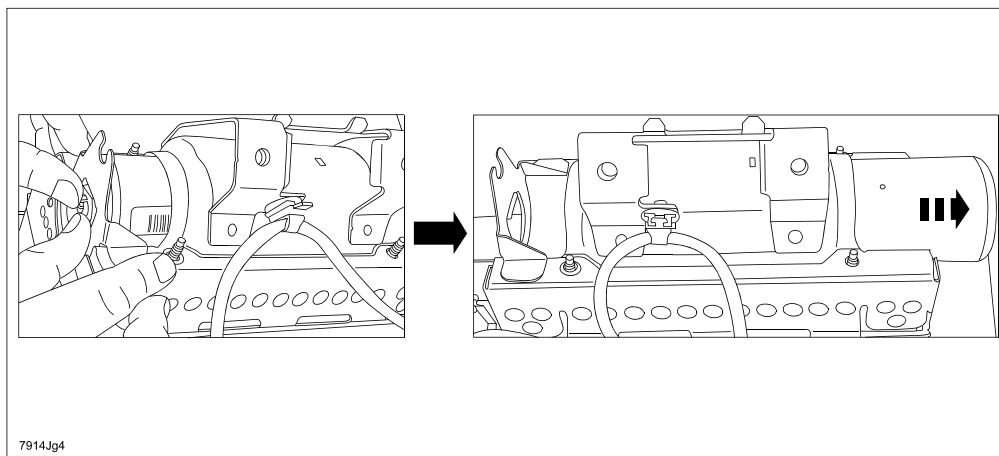

6. Insert the modified inflator from the opposite side of where the yellow identification tape (A) is located.

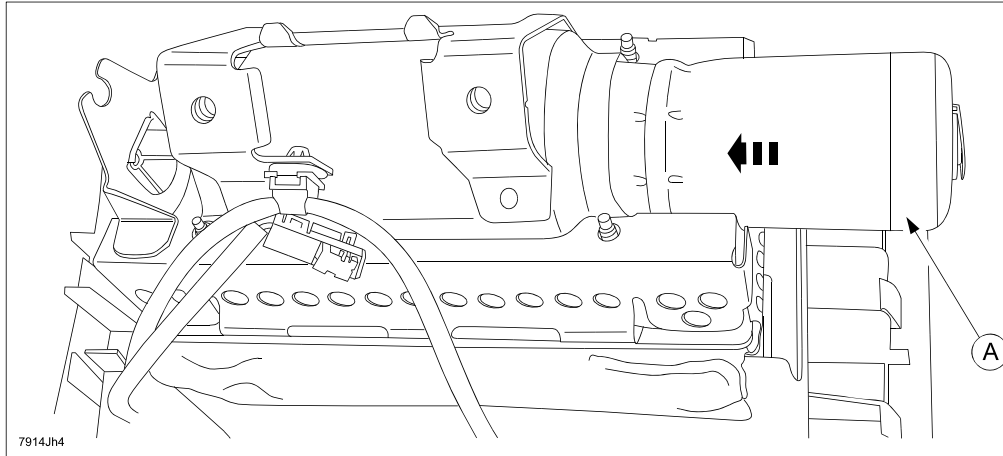

7. Insert the inflator up to the position where it touches the stopper (A), aligning the D-shape end of the inflator with the stopper opening (B).

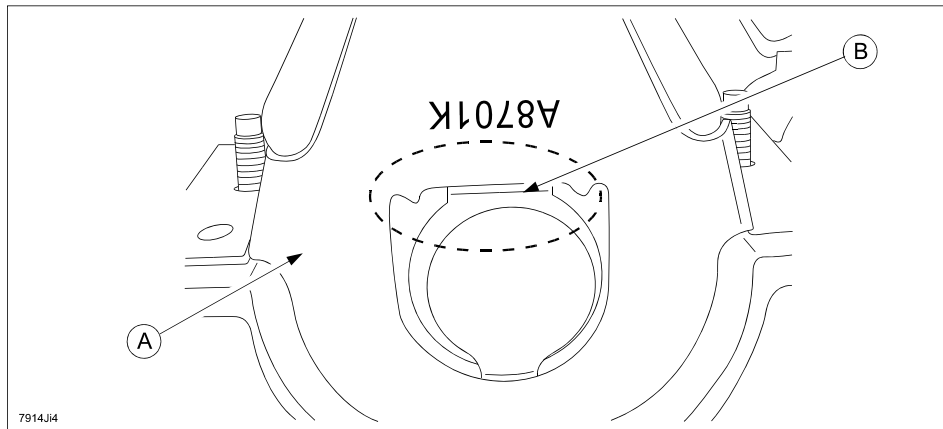

8. Set the new stopper plate (A) by gently pushing until it touches with the inflator side (B).

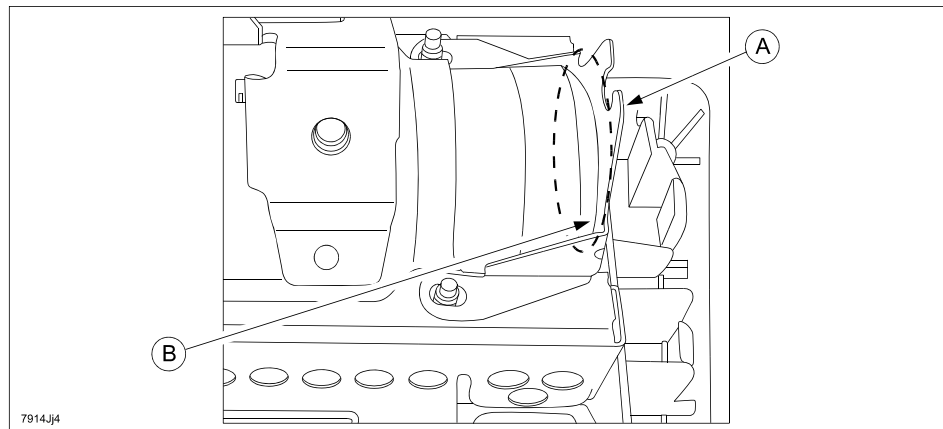

9. Keeping the position above, hand tighten the four (4) new nuts.

10. Tighten the four (4) new nuts to the specified torque in the order shown below (1, 2, 3, 4).  
**Tightening Torque: 35 +/- 1.8 in-lbf. {39.8 +/- 2.0 kgf-cm, 3.9 +/- 0.4 Nm}**

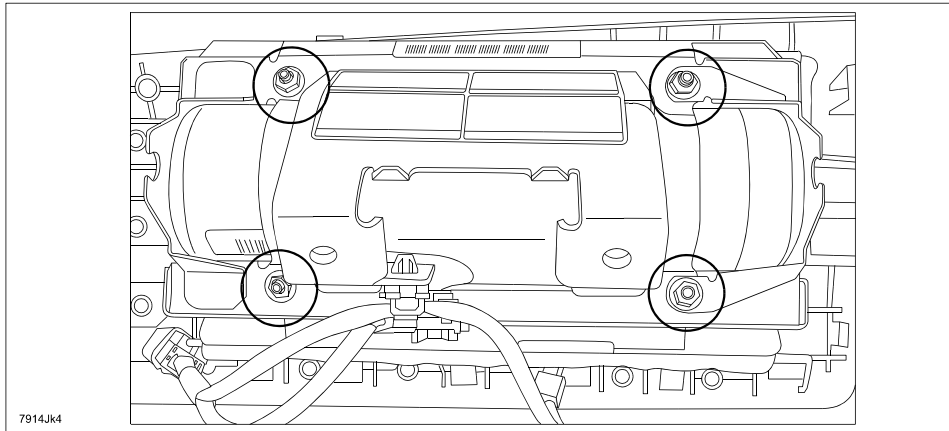

11. Remove the seal (A) from the end of the inflator on both sides.

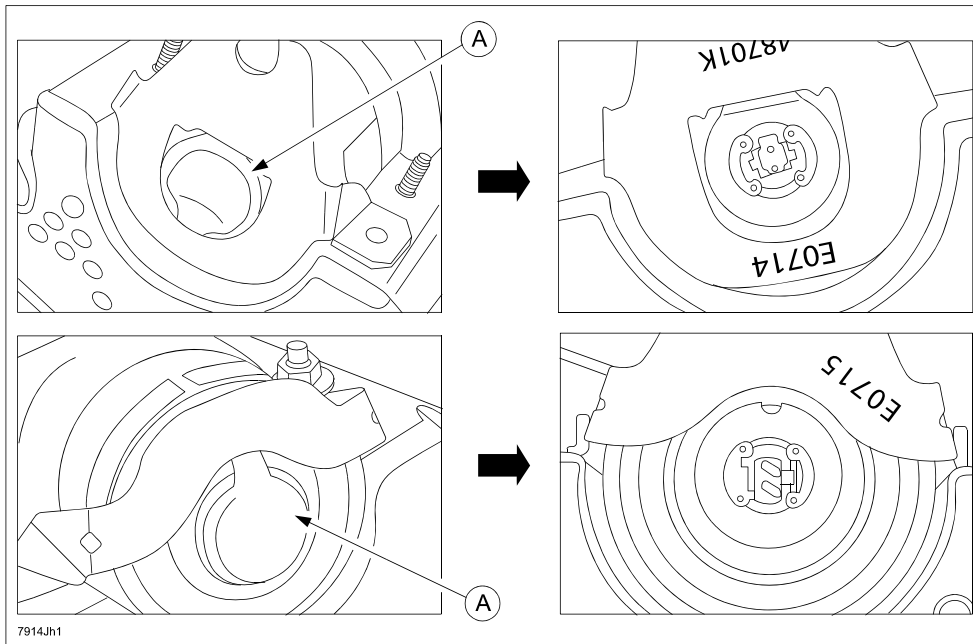

12. Securely lock the connectors by depressing the stoppers on the back of the connector (A).

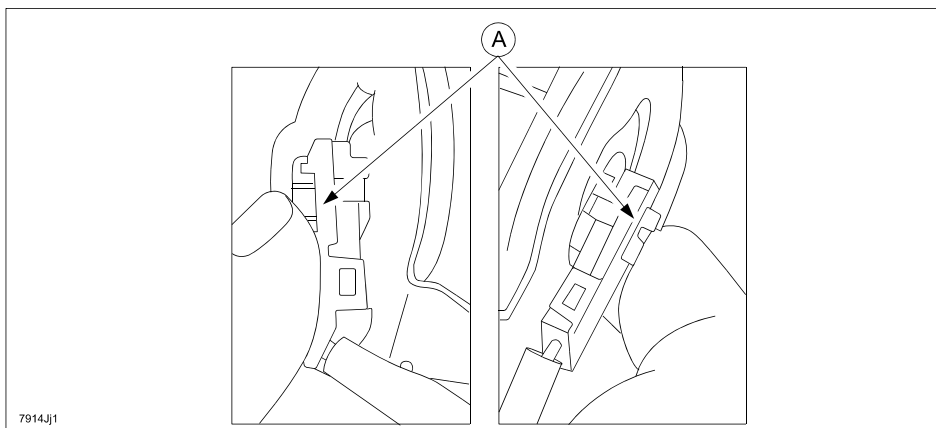

**Air Bag Module Reinstallation:**

1. Re-connect the connector (B), then install the air bag module (A) and the bolt (C).  
**Tightening Torque: 60.8 - 86.7in-lbf. {70 - 100 kgf-cm, 6.8 - 9.8 Nm}**

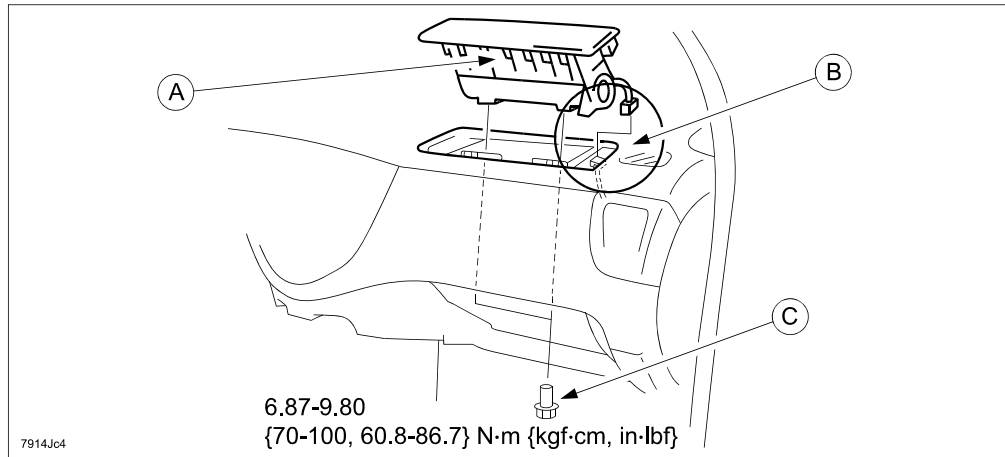

2. Install the connector as shown.

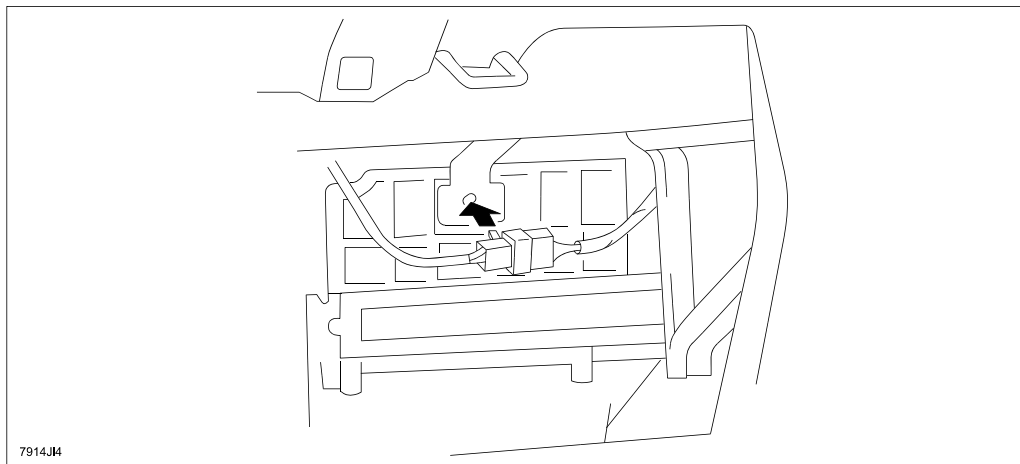

3. Reconnect the negative battery cable.
4. Turn the ignition switch to the ON position.
5. Verify that the air bag system warning light illuminates for approx. 6 sec., then goes out.

**NOTE:** If the air bag system warning light does not operate in the manner described above, there is a malfunction in the system. Inspect the system following the on-board diagnostic system procedure according to MS3 online or the Workshop Manual (section 08 Restraints).

6. Reinstall the glove box.
7. Re-enter the customer's preset radio stations.
8. Proceed to "C. CAMPAIGN LABEL INSTALLATION".



**2004 B-Series:**

**Passenger-Side Air Bag Inflator Replacement Procedure:**

Parts Information: The service parts are available in one box.

**Outline:**

1. Remove the inflator from the passenger-side air bag module (A), then replace it with a modified one (B) identified with a yellow stripe (C).

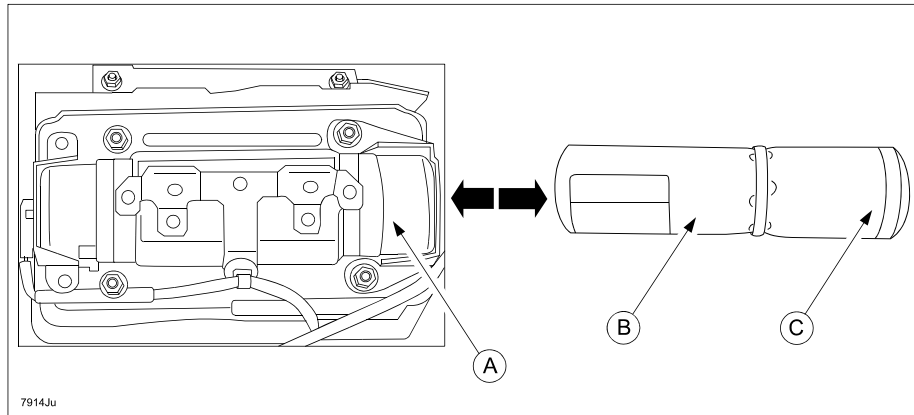

2. Pack and return the removed inflator as follows:

**IMPORTANT: Be sure to follow the packing and shipping instructions provided in the carton and in Attachment IV, Air Bag Inflator Return Instructions.**

**CAUTION:**

- Use the same carton which was used to deliver a new inflator. It is a specialized box that is internationally accepted for shipping an inflator.
- Pack the old inflator in the box exactly in the same manner as the new inflator was packed.

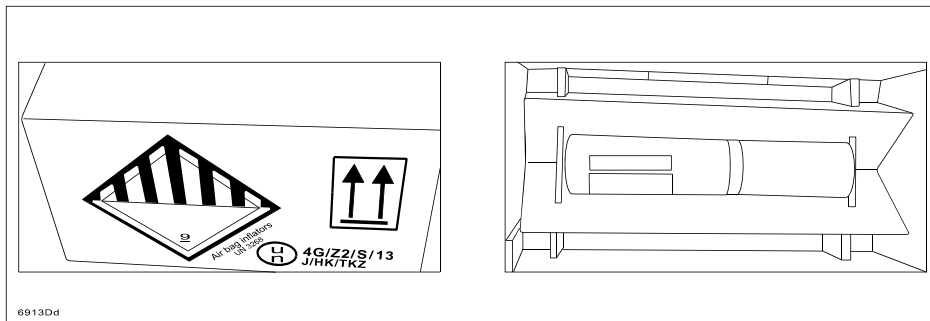

**Air Bag Module Removal:****WARNING:**

- Perform the replacement in a clean environment. Oil, grease, water, etc. on components may cause the air bag modules to fail to deploy in an accident, which may cause serious injury. Do not allow oil, grease, water, etc., on components.
  - Inserting a screwdriver, etc., into the connector of an air bag module may damage the connector and cause the air bag module to deploy improperly, which may cause serious injury. Do not insert any foreign objects into the connector.
  - Do not disassemble the vehicle, other than instructed here.
  - Do not make an attempt to directly supply electrical power to the module and the inflator.
  - Keep the module facing of the pad surface upwards at all times, except during replacement.
  - Do not use the module and new inflator if they were dropped on the ground.
  - Avoid module and inflator exposure to temperatures of 194 degrees F (90 degrees C) or more.
1. Turn the ignition switch to the LOCK position.
  2. Record the customer's preset radio stations.
  3. Disconnect the negative battery cable and wait for one (1) minute or more.
  4. Open the glove compartment door to access the passenger air bag electrical connector.

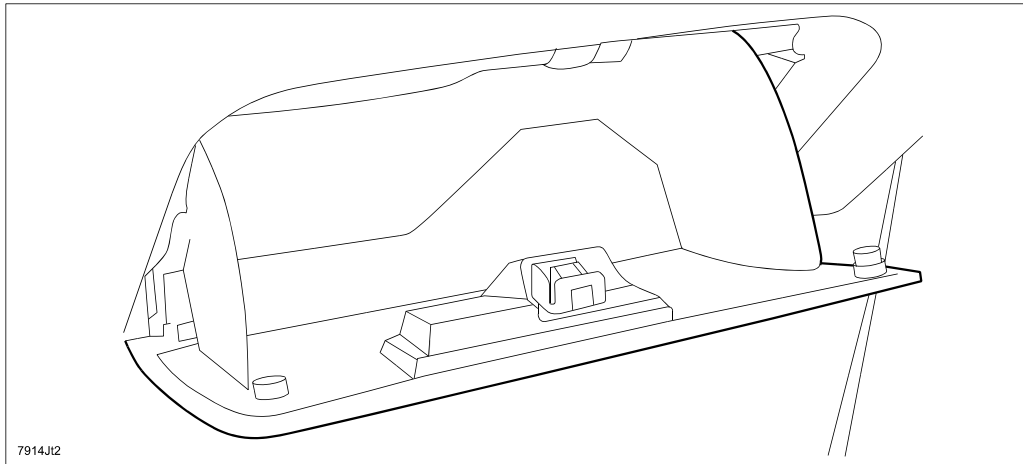

5. Release the tab and disconnect the passenger air bag module electrical connector

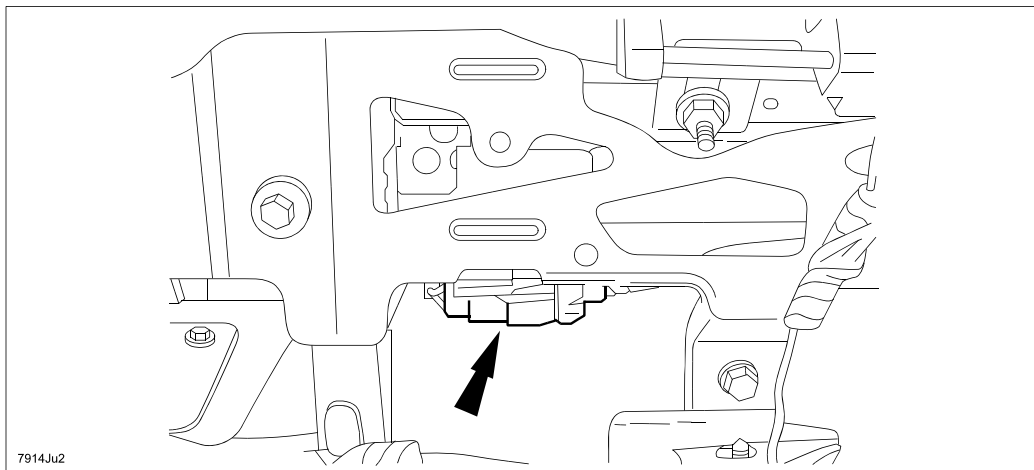

6. Remove the two passenger air bag module bolts (A).

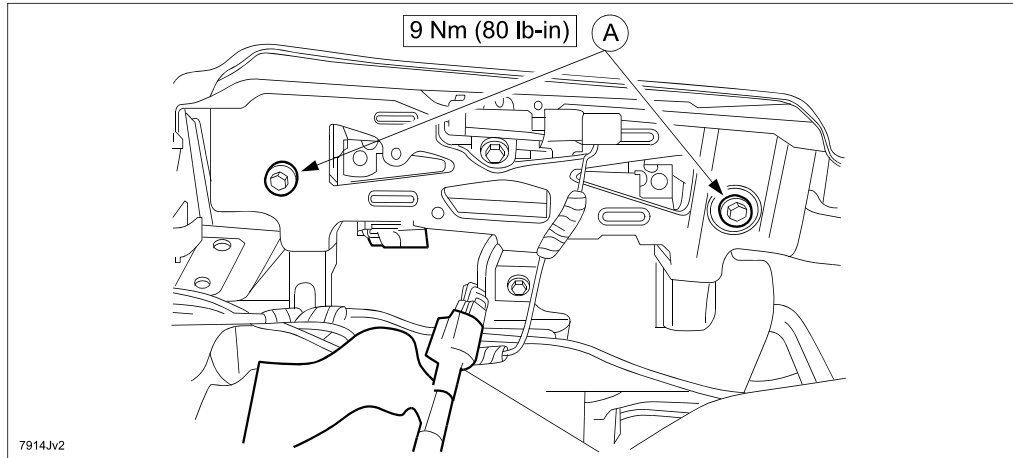

7. Remove the passenger airbag. If necessary, push down on the top and up on the bottom of the deployment door while pushing out on the passenger air bag module, releasing the clips from the instrument panel and remove the passenger air bag module

**CAUTION:** Do not handle the passenger air bag module by grabbing the edges of the deployment doors. Place one hand in the glove compartment and push the passenger air bag out.

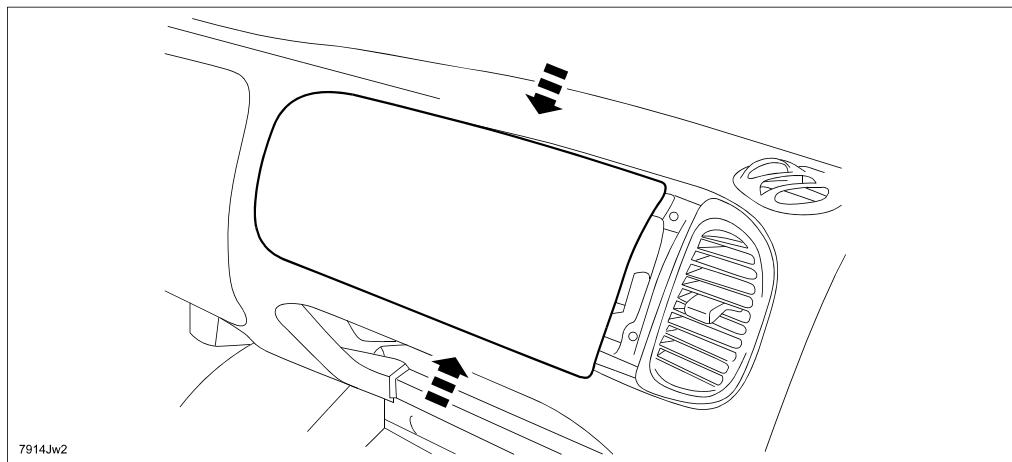

**Inflator Replacement:**

1. Set the airbag face down onto a surface that will not scratch or damage the airbag face.
2. Remove the wiring harness connector retaining clip (A) from the wiring harness connector. (B)

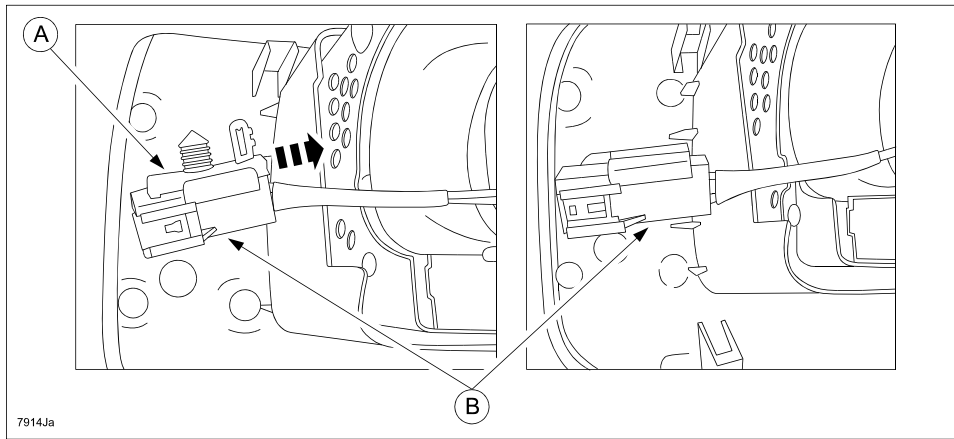

3. Remove the two airbag inflator retaining bracket nuts (A) and the airbag inflator retaining bracket (B). Discard the nuts.

**WARNING:** Do not allow any debris or retainers on or around the airbag once the inflator is removed.

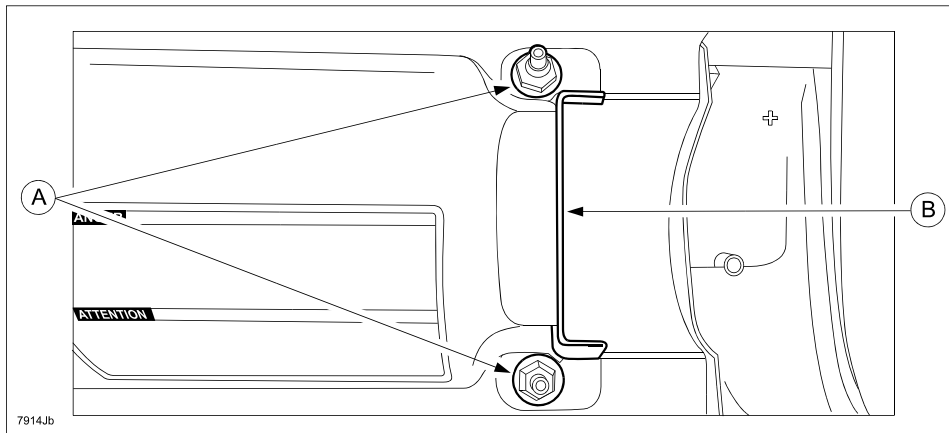

- With an assistant holding the airbag assembly, remove the inflator (A) from the airbag assembly by pushing outward on the inflator. Set the airbag inflator aside for return shipping.

**IMPORTANT:**

- If required, use of a brass punch (B) is permitted only at the location shown to free the inflator from its mounted position.
- Return the removed inflator in the same carton in which the new part was received. Carefully follow the packing and shipping instructions included in the carton.

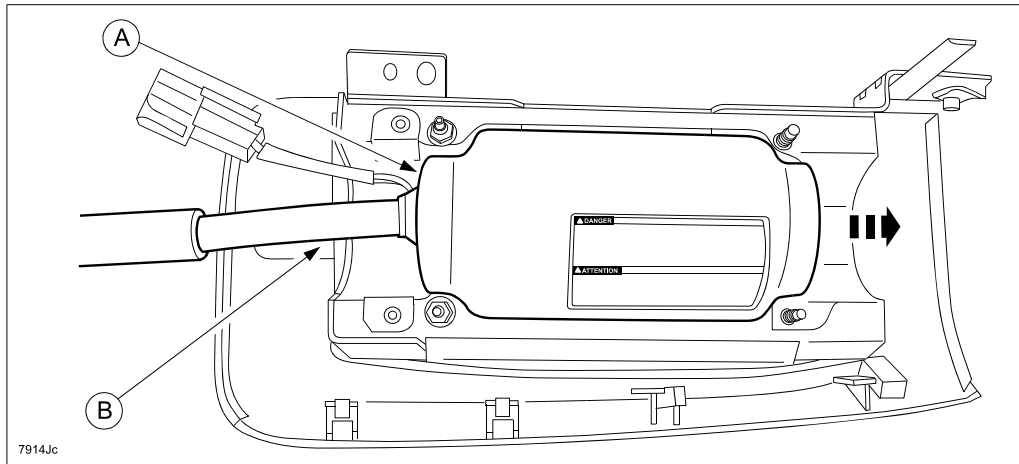

- Install the new passenger side airbag inflator into the airbag assembly.

**NOTE:**

- The new airbag inflator can be identified by a yellow stripe (A).
- The indexed end of the airbag inflator must be installed first (B) to mate with the permanently mounted bracket.

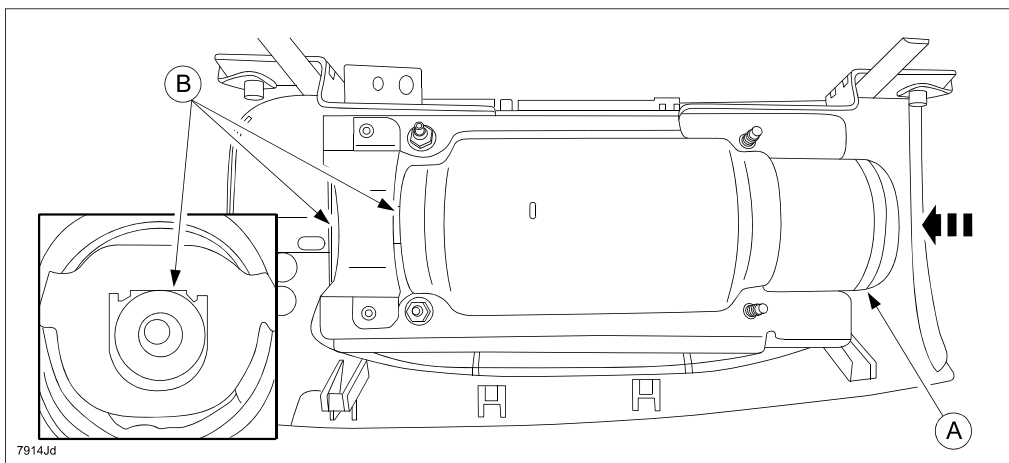

6. Install the passenger side air bag inflator retaining bracket (B) and install the two nuts (A).  
**Tightening Torque: 35 +/- 1.8 in-lbf. {39.8 +/- 2.0 kgf-cm, 3.9 +/- 0.4 Nm}**

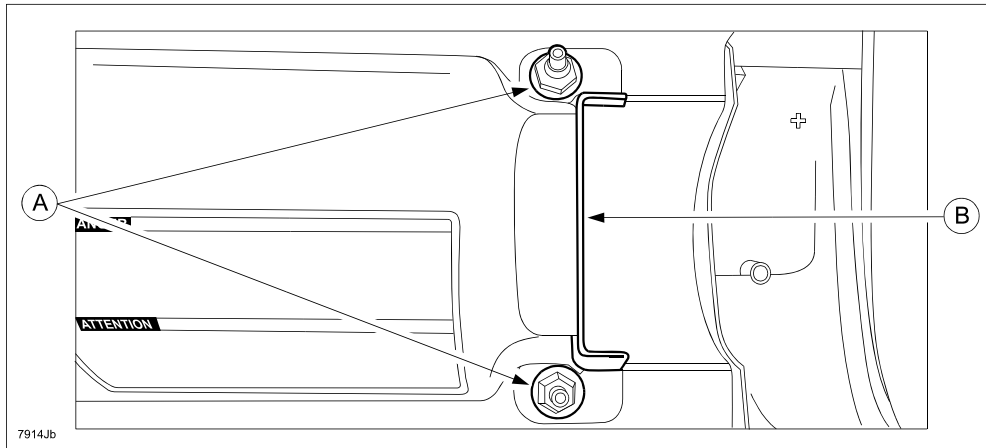

7. Connect the new wiring harness (A) to the passenger air bag inflator.

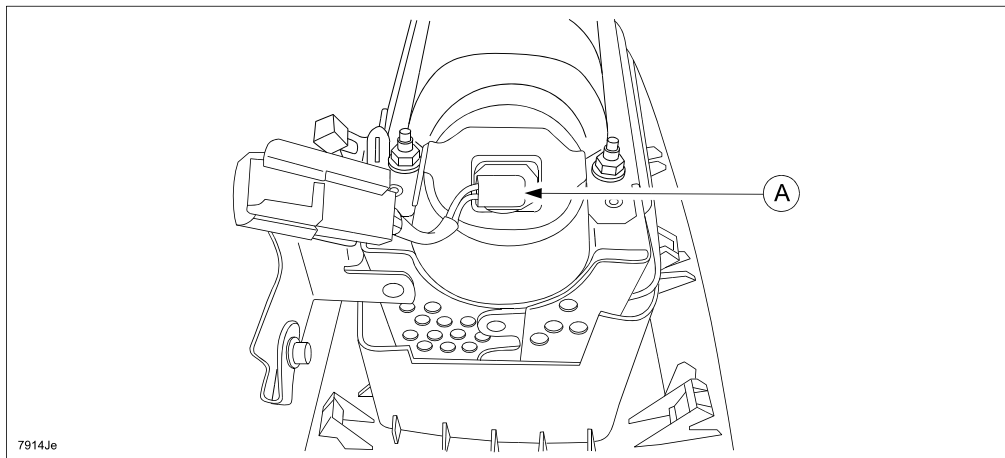

**Air Bag Module Reinstallation:**

1. Install the air bag module assembly. Angle the top of the passenger air bag module into the instrument panel first so that the deployment door upper clips engage to the instrument panel. Push up and in at the top and down and in at the bottom of the deployment door to seat all the clips to the instrument panel.

**CAUTION:** DO NOT handle the passenger air bag module by grabbing the edges of the deployment doors. Position the passenger air bag module into the instrument panel.

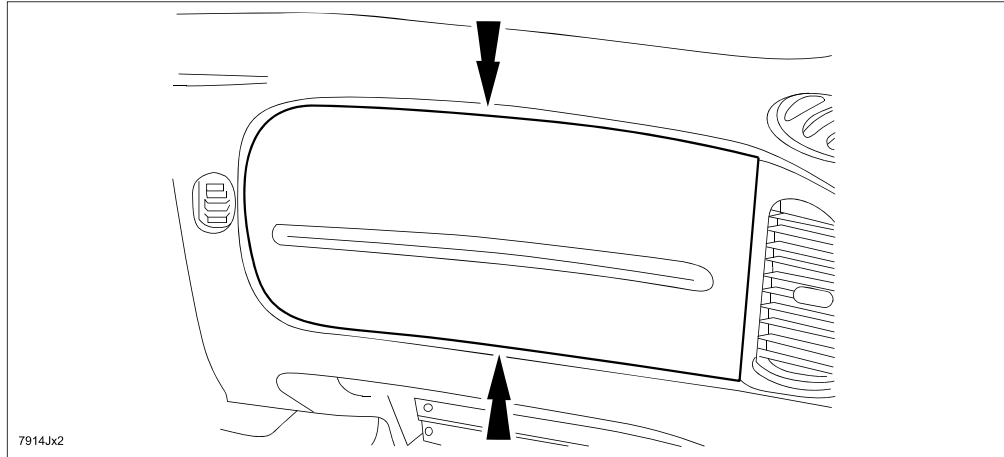

2. Align the passenger air bag module and install the bolts (A).  
**Tightening Torque: 80 in-lbf. {9 Nm}**

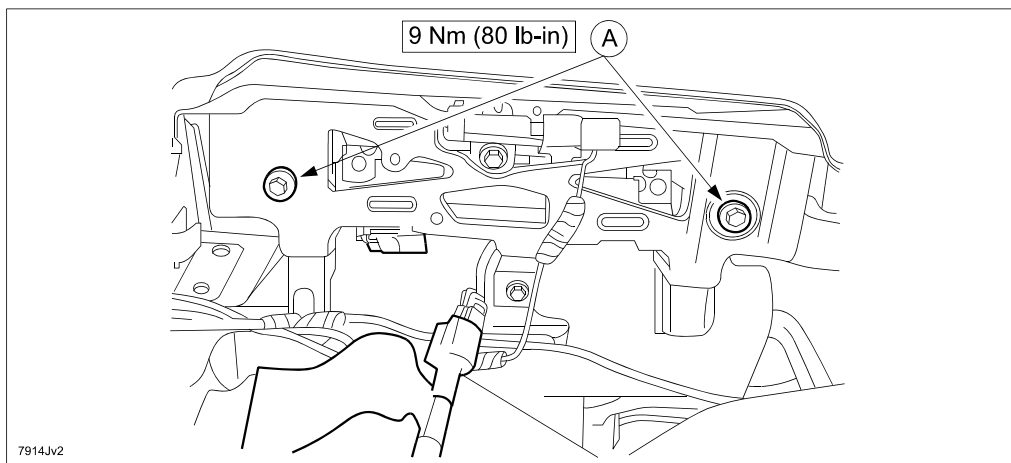

3. Connect the passenger air bag module electrical connector.

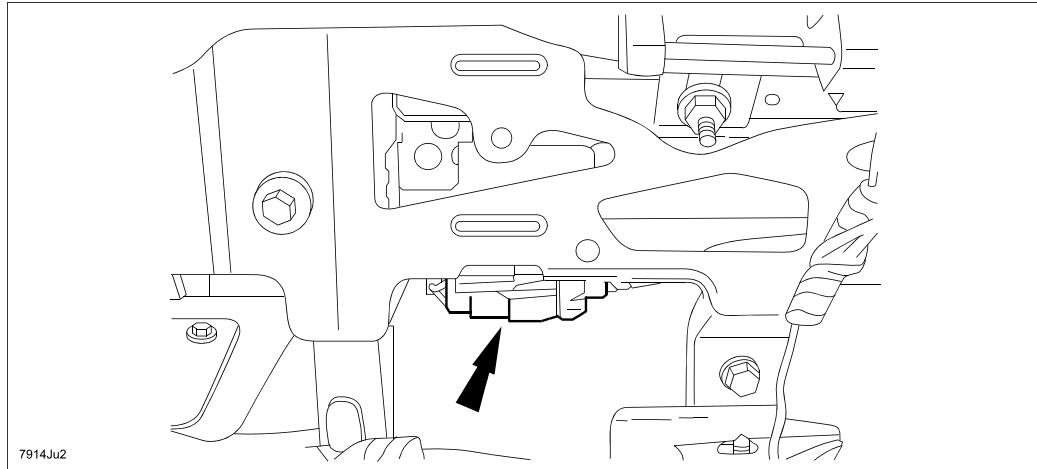

4. Close the glove compartment door.
5. Reconnect the negative battery cable.
6. Turn the ignition switch to the ON position.
7. Verify that the air bag system warning light illuminates for approx. 6 sec., then goes out.

**NOTE:** If the air bag system warning light does not operate in the manner described above, there is a malfunction in the system. Inspect the system following the on-board diagnostic system procedure according to MS3 online or the Workshop Manual (section 08 Restraints).

8. Re-enter the customer's preset radio stations.
9. Proceed to "C. CAMPAIGN LABEL INSTALLATION".