

<b>Subject:</b> HESITATION / IDLE VIBRATION DUE TO CRACKED ENGINE MOUNT	<b>Bulletin No:</b> 01-001/09
	<b>Last Issued:</b> 1/20/2009

## BULLETIN NOTE

- This bulletin supersedes the previous bulletin 01-021/06, issued 6/13/2006. The DESCRIPTION, REPAIR PROCEDURE, PART(S) INFORMATION and WARRANTY INFORMATION sections have been revised.
- Changes are noted below beside the change bar in Red.

## APPLICABLE MODEL(S)/VINS

2004-2005 RX-8 vehicles with VINs lower than JM1FE\*\*\*\*\*154999 (produced before May 6, 2005)

## DESCRIPTION

Some vehicles may experience the following symptoms.

- On manual transmission vehicles, when decelerating in 3rd gear with engine speed less than 3,000 RPM at approximately 30 MPH (50km/h), then quickly depressing the accelerator pedal again, a hesitation may occur. This symptom can only be observed in this engine speed and vehicle speed range.
- On automatic transmission vehicles, when at a stop in D range, excessive engine/body vibration may occur. This body vibration does not occur in P or N range.

Depending on the driving condition or engine condition, the RH side engine mount rubber may deform. As a result, the RH side engine mount can crack. As a mass production change, the material of the engine mount rubber has been changed.

Customers having this concern should have their vehicle repaired using the following procedure.

## REPAIR PROCEDURE

### NOTE:

- RH engine bracket replacement is no longer necessary.
1. Verify customer concern.
  2. Place vehicle on hoist.
  3. Remove engine cover. Refer to MS3 online service information or Workshop Manual section 01-10 ENGINE COVER REMOVAL/INSTALLATION procedure.
  4. Raise and support vehicle on hoist.
  5. Remove front wheels.  
**Tightening Torque: 147 N.m (108 ft-lb)**
  6. Support engine using an engine hoist.

7. On RH side of engine, remove bolts/nuts in the following order:

- a. Engine mount bracket-to-engine mount (1).  
**Tightening Torque: 37-52 N.m (28-38 ft-lb)**
- b. Engine mount-to-front sub frame (2).  
**Tightening Torque: 45-63 N.m (33-46 ft-lb)**

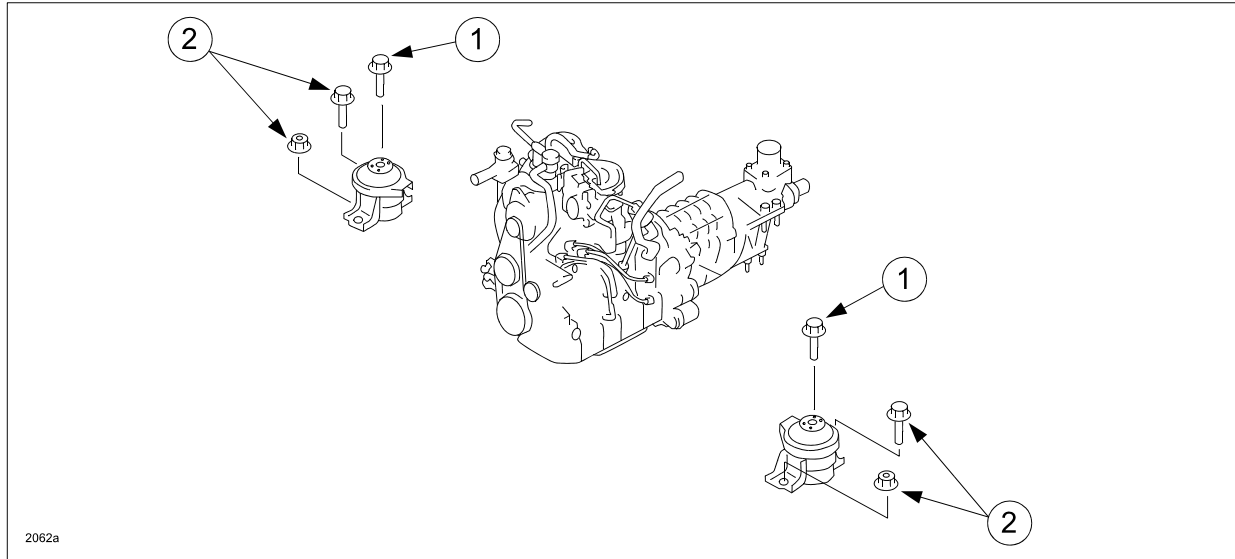

8. On LH side of engine, remove bolts/nuts in the following order:

- a. Engine mount bracket-to-engine mount (1).  
**Tightening Torque: 37-52 N.m (28-38 ft-lb)**
- b. Engine mount-to-front sub frame (2).  
**Tightening Torque: 45-63 N.m (33-46 ft-lb)**

9. To install, reverse removal procedure.

10. Verify repair.

## PART(S) INFORMATION

Part Number	Description	Qty.	Notes
FE05-39-040	Engine Mount Rubber - MT	1	RH
FE05-39-050	Engine Mount Rubber - MT	1	LH
FE01-39-040	Engine Mount Rubber - AT	1	RH
FE01-39-050	Engine Mount Rubber - AT	1	LH

## WARRANTY INFORMATION

### NOTE:

- This warranty information applies only to verified customer complaints on vehicles eligible for warranty repair.
- The previous Warranty Information will be void in MC warranty processing system effective on January 31, 2009.
- As for the left-side of engine mount rubber, claim it as a related part.
- This repair will be covered under Mazda's New Vehicle Limited Warranty term.
- Additional diagnostic time cannot be claimed for this repair.

Warranty Type	A
Symptom Code	83
Damage Code	9M
Part Number Main Cause	FE05-39-040 or FE01-39-040
Quantity	1
Operation Number / Labor Hours:	XXD5BXRX / 0.8 Hrs.